

## RETROFIT KIT

# RETROFIT

## SOLUTIONS

### Great Affordable Solutions for:

- ✓ Replacing obsolete or sub-standard locks
- ✓ Adding remote capability to existing manual doors

## Airteq Defender

**Allows for the replacement of existing locks from any manufacturer with a high security UL Listed electric lock.**

- ▶ ASTM - Lock Tested
- ▶ Surface Mounted
- ▶ Anti-Suicide Design
- ▶ Designed To Prevent 'Sheeting' Or 'Popping' Of The Latchbolt
- ▶ Existing Mogul Or Mortise Key Cylinders May Be Reused If Desired
- ▶ Integral Security Door Position Switch (DPS) Available
- ▶ LED Secure Door Indicator Option
- ▶ Optional Door Stop on Integrated Flush Pull

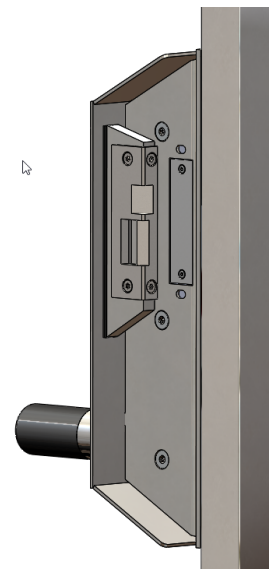
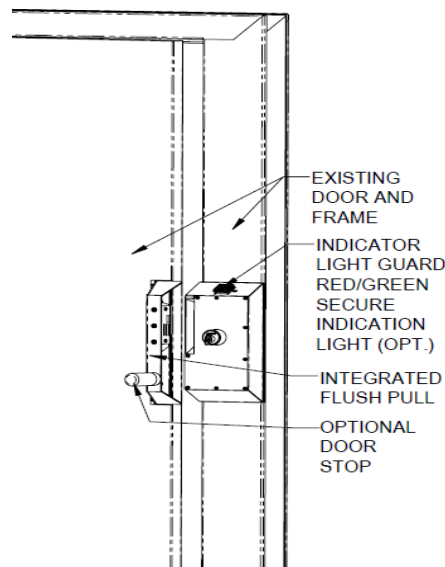

# AIRLOCK 9900



The **9900** provides for pneumatic or manual locking / unlocking of swinging doors. It can be operated from a remote location or by key at the door. For additional security, it is recommended that the 9900 lock be used with an Airteq high security door position sensor. An automatic door closer may also be used.

## APPLICATION:

Swing door lock for entrances, safety vestibules, corridors, inmate housing. Suitable for exterior locations. Gate mount available.

## SECURITY LEVEL:

ASTM F 1577 Grade 1

## KEY CYLINDER:

Mogul cylinder or builders key cylinder with mogul sleeve (sold separately).

## MOUNTING:

Jamb mounted with either hinge side or stop side access cover.

## FIRE RATING:

UL10B - 3 Hour

(not available with these functions: RLHB, KLHB, ELHB, & RMERS)

## STANDARD OPERATION

- Latchbolt retracts when power is applied to the lock and remains retracted until the door is opened approximately 2". Door relocks when closed.
- Provides automatic deadlocking, even in the event of a total loss of power.
- Fail secure, unlocks when energized.

## STANDARD FEATURES

- Latch bolt has a full 1" throw
- Slam-locking with automatic mechanical deadlock
- Roller-type deadlock actuator
- Lock status switch indicates deadlocked latchbolt
- Keyed one or two sides
- Stainless Steel Strike/Keeper furnished with tamper resistant screws
- Quick connect air and electrical connectors
- Factory wired field-side pigtail
- RLB (Remote Latch Back)  
When unlocked, the latchbolt remains retracted until door is opened
- Plated and stainless steel parts

**AIR//TEQ**

2511 Midpark Rd., Montgomery, AL 36109  
Phone: (800) 466-3007 Fax: (334) 286-6421



# TECHNICAL SPECIFICATIONS

9900

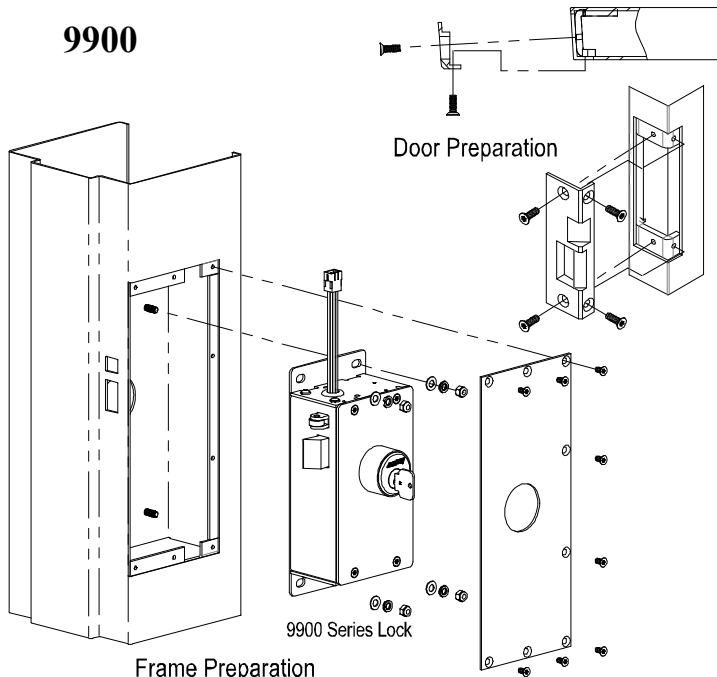

- **Body:** All steel construction
- **Dimensions:** 12"H x 5 7/16W x 3 1/2"D
- **Latchbolt:** Hardened Stainless Steel
- **Latchbolt Throw:** 1" - Flush when retracted
- **Deadlock Actuator:** Roller type, stainless steel
- **Lock Status Switch:** 15 amp rated, UL recognized
- **Electrical Power Consumption:** 24VDC  
1.5 watt max (.063 amps)
- **Solenoid Valve:** 24 VDC continuous rated
- **Operating Range:** 24 VDC ± 2 VDC
- **Air Pressure Range:** 70 to 125 p.s.i.
- **Electrical Connector:** Quick Connect electrical plug
- **Strike/Keeper:** Hardened Stainless Steel with pin-torx screws
- **UL10B:** 3 hour fire rating (see fire rating exceptions on cover page)
- **ASTM F 1577 Grade 1 Certified**

Frame Preparation

Note: Drawing for illustration only. Reference template for

## HOW TO SPECIFY AND ORDER AN AIRTEQ 9900 LOCK

## SWING/HAND CHART

WHEN SPECIFYING ...						ALSO SPECIFY ...										
MODEL NO.	X	"K1" OR "K2"	X	FINISH	X	SCREW HEAD STYLE	X	OPTIONAL FEATURES	-CYLINDER TYPE & MANUFACTURER -CYLINDER EXTENSION IF REQUIRED							
* WHEN ORDERING ...																
MODEL NO.	X	SWING CODE	X	CYL. TYPE & MFR.	X	FRAME CONDITION	X	FINISH	X	SCREW HEAD STYLE	X	OPTIONAL FEATURES	X	JAMB DEPTH (WHERE REQ.)	X	DOOR THK.

SWING CODE	DOOR HAND DIAGRAM * is COVER PLATE SIDE	SWING CODE	DOOR HAND DIAGRAM * is COVER PLATE SIDE
07 LHRB		08 RHRB	
09 RH		10 LH	
11 LHRB		12 RHRB	
13 RH		14 LH	

EXAMPLE A: SPECIFICATION READS... "KEYED 1 SIDE, MOGUL CYLINDER & KEY SWITCH"

WHEN SPECIFYING ...  
9900 X K1 X US32D X TORX X KS

\* WHEN ORDERING ...  
9900 X 13 X AIRTEQ MOGUL X FR. POCKET X US32D X TORX X KS X 2"DR.

EXAMPLE B: SPECIFICATION READS... "KEYED 2 SIDES, CYLINDER EXTENSION & NO LATCHBACK REQUIRED"

WHEN SPECIFYING ...  
9900 X K2 X US32D X TORX X KCE X NRLB

\* WHEN ORDERING ...  
9900 X 08 X ASSA MOGUL X KCE X US32D X TORX X NRLB X 9"JD X 2"DR.

\* TEMPLATE NO. AND LATEST REVISIONS SHOULD BE COORDINATED WITH THE DOOR AND FRAME MANUFACTURER

### Optional Features

- ♦ **KR** - Knob Release: Latchbolt is retracted by knob release on one side of lock. Knob is always active. When ordering, specify hinge side (HS) or stop side (SS).
- ♦ **KCE** - Key Cylinder Extension: Recommended for locks keyed stop side or keyed two sides.

### Optional Functions

- ♦ **NRLB** - No Remote Latch Back: Latch bolt extends immediately when power is removed or key is moved to the locked position.
- ♦ **KS** - Key Switch: Door is electrically unlocked by key operated switch at the lock. Can be disabled by the control system.
- ♦ **LEK** - Local Electric Key Switch: Provides for one key which operates lock electrically only, while higher level keys will operate it both mechanically and electrically. Includes 'KS' function plus a special function key cylinder.
- ♦ **KLHB** - Key operated Latch Hold Back: Latch is retracted locally by key and remains mechanically retracted until relocked by key.
- ♦ **ELHB** - Emergency Latch Hold Back: Latch bolt is retracted remotely and remains mechanically retracted until relocked at the door by key
- ♦ **RLHB** - Remote Latch Hold Back: Latch bolt is retracted by unlock control signal and remains retracted until lock receives a relock control signal. RLHB is typically combined with NRLB

**NOTE: PLEASE CONTACT AIRTEQ WHEN MORE THAN ONE FUNCTION IS REQUIRED ON THE SAME LOCK.**

### Warranty

Airteq warrants its products against defects in material or workmanship for one year from the time of delivery. Airteq's sole obligation under the warranty is to repair, or at its option, to replace the product. The buyer shall have no other remedy. (All special, incidental and coincidental damages are excluded.) Written notice of breach of warranty must be given to Airteq within the warranty period. The warranty does not cover damages resulting from improper installation or maintenance, accident or misuse. NO OTHER WARRANTIES AS TO MERCHANTABILITY OR OTHERWISE ARE MADE. A continuing product research program is ongoing. Airteq reserves the right to incorporate products and specification changes at any time without notice.

# MOTORLOCK 9912M

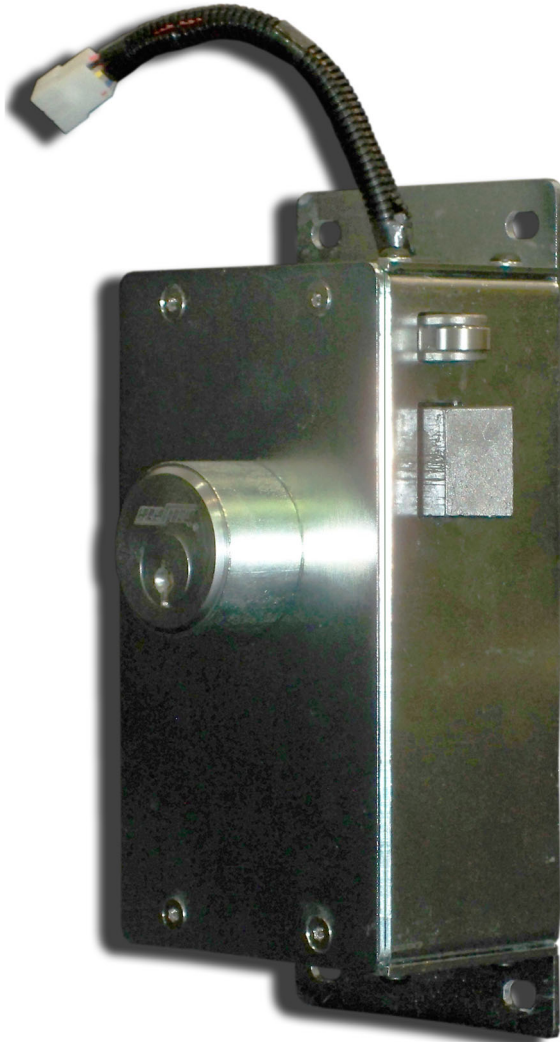

The **9912M** provides for electric or manual locking / unlocking of swinging doors. It can be operated from a remote location or by key at the door. For additional security, it is recommended that the 9912M lock be used with an Airteq high security door position sensor. An automatic door closer may also be used.

## APPLICATION:

Swing door lock for entrances, safety vestibules, corridors, inmate housing. Suitable for exterior locations.

## SECURITY LEVEL:

ASTM F 1577 Grade 1

## KEY CYLINDER:

Mogul cylinder or builders key cylinder with mogul sleeve (sold separately).

## MOUNTING:

Jamb mounted with either hinge side or stop side access cover.

## FIRE RATING:

UL10B - 3 Hour

(not available with these functions: KLHB,ELHB & RLHB)

## STANDARD FEATURES

- Latch bolt has a full 1" throw
- Slam-locking with automatic mechanical deadlock
- Roller-type deadlock actuator
- Lock status switch indicates deadlocked latchbolt
- Keyed one or two sides
- Stainless Steel Strike/Keeper furnished with tamper resistant screws
- Quick connect electrical connectors
- Factory wired field-side pigtail
- RLB (Remote Latch Back)  
When unlocked, the latchbolt remains retracted until door is opened
- Plated and stainless steel parts

## STANDARD OPERATION

- Latchbolt retracts when power is applied to the lock and remains retracted until the door is opened approximately 2". Door relocks when closed.
- Provides automatic deadlocking, even in the event of a total loss of power.
- Fail secure, unlocks when energized.



2511 Midpark Rd., Montgomery, AL 36109  
Phone: (800) 466-3007 Fax: (334) 286-6421



# TECHNICAL SPECIFICATIONS

## 9912M

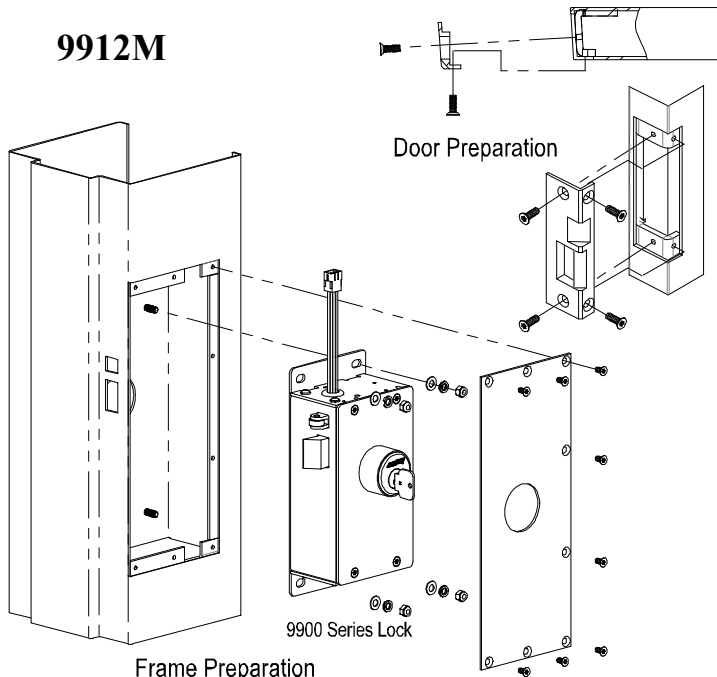

- **Body:** All steel construction
- **Dimensions:** 12"H x 5 7/16W x 3 1/2"D
- **Latchbolt:** Hardened Stainless Steel
- **Latchbolt Throw:** 1" - Flush when retracted
- **Deadlock Actuator:** Roller type, stainless steel
- **Lock Status Switch:** 15 amp rated, UL recognized
- **Electrical Power Consumption:** 120VAC, 1 phase 60hz  
2.5 amp in-rush, 1.75 amp running
- **Electrical Connector:** Quick Connect electrical plug
- **Strike/Keeper:** Hardened Stainless Steel with pin-torx screws
- **UL10B:** 3 hour fire rating (see fire rating exceptions on cover page)
- **ASTM F 1577 Grade 1 Certified**

Note: Drawing for illustration only. Reference template for specific information

## HOW TO SPECIFY AND ORDER AN AIRTEQ 9912M LOCK

WHEN SPECIFYING . . .						ALSO SPECIFY . . .			
MODEL NO.	"K1" OR "K2"	FINISH	SCREW HEAD STYLE	OPTIONAL FEATURES		CYLINDER TYPE & MANUFACTURER	CYLINDER EXTENSION IF REQUIRED		
MODEL NO.	X	X	X	X	X	X	X	X	X
* WHEN ORDERING . . .									
MODEL NO.	SWING CODE	CYL. TYPE & MFR.	FRAME CONDITION	FINISH	SCREW HEAD STYLE	OPTIONAL FEATURES	JAMB DEPTH (WHERE REQ.)	DOOR THK.	
MODEL NO.	X	X	X	X	X	X	X	X	X

EXAMPLE A: SPECIFICATION READS . . . "KEYED 1 SIDE, MOGUL CYLINDER & KEY SWITCH"  
WHEN SPECIFYING . . .  
9912M X K1 X US32D X TORX X KS  
\* WHEN ORDERING . . .  
9912M X 13 X AIRTEQ MOGUL X FR. POCKET X US32D X TORX X KS X 2"DR.

EXAMPLE B: SPECIFICATION READS . . . "KEYED 2 SIDES, CYLINDER EXTENSION & NO LATCHBACK REQUIRED"  
WHEN SPECIFYING . . .  
9912M X K2 X US32D X TORX X KCE X NRLB  
\* WHEN ORDERING . . .  
9912M X 08 X ASSA MOGUL X KCE X US32D X TORX X NRLB X 9"JD X 2"DR.

\* TEMPLATE NO. AND LATEST REVISIONS SHOULD BE COORDINATED WITH THE DOOR AND FRAME MANUFACTURER

## SWING/HAND CHART

SWING CODE	DOOR HAND DIAGRAM * is COVER PLATE SIDE	SWING CODE	DOOR HAND DIAGRAM * is COVER PLATE SIDE
07 LHRB		08 RHRB	
09 RH		10 LH	
11 LHRB		12 RHRB	
13 RH		14 LH	

### Optional Features

- ◆ **KR** - Knob Release: Latchbolt is retracted by knob release on one side of lock. Knob is always active. When ordering, specify hinge side (HS) or stop side (SS).
- ◆ **KCE** - Key Cylinder Extension: Recommended for locks keyed stop side or keyed two sides.

### Optional Functions

- ◆ **NRLB** - No Remote Latch Back: Latch bolt extends immediately when power is removed or key is moved to the locked position.
- ◆ **KS** - Key Switch: Door is electrically unlocked by key operated switch at the lock. Can be disabled by the control system.
- ◆ **LEK** - Local Electric Key Switch: Provides for one key which operates lock electrically only, while higher level keys will operate it both mechanically and electrically. Includes 'KS' function plus a special function key cylinder.
- ◆ **KLHB** - Key operated Latch Hold Back: Latch is retracted locally by key and remains mechanically retracted until relocked by key.
- ◆ **ELHB** - Emergency Latch Hold Back: Latch bolt is retracted remotely and remains mechanically retracted until relocked at the door by key
- ◆ **RLHB** - Remote Latch Hold Back: Latch bolt is retracted by unlock control signal and remains retracted until lock receives a relock control signal. RLHB is typically combined with NRLB

**NOTE: PLEASE CONTACT AIRTEQ WHEN MORE THAN ONE FUNCTION IS REQUIRED ON THE SAME LOCK.**

### Warranty

Airteq warrants its products against defects in material or workmanship for one year from the time of delivery. Airteq's sole obligation under the warranty is to repair, or at its option, to replace the product. The buyer shall have no other remedy. (All special, incidental and coincidental damages are excluded.) Written notice of breach of warranty must be given to Airteq within the warranty period. The warranty does not cover damages resulting from improper installation or maintenance, accident or misuse. NO OTHER WARRANTIES AS TO MERCHANTABILITY OR OTHERWISE ARE MADE. A continuing product research program is ongoing. Airteq reserves the right to incorporate products and specification changes at any time without notice.



# MOTORLOCK 9924



The **9924** provides for electric or manual locking / unlocking of swinging doors. It can be operated from a remote location or by key at the door. For additional security, it is recommended that the 9924 lock be used with an Airteq high security door position sensor. An automatic door closer may also be used.

## APPLICATION:

Swing door lock for entrances, safety vestibules, corridors, inmate housing. Suitable for exterior locations.

## SECURITY LEVEL:

ASTM F 1577 Grade 1

## KEY CYLINDER:

Mogul cylinder or builders key cylinder with mogul sleeve (sold separately).

## MOUNTING:

Jamb mounted with either hinge side or stop side access cover.

## FIRE RATING:

UL10B - 3 Hour

(not available with these functions: KLHB,ELHB & RLHB)

## STANDARD FEATURES

- Latch bolt has a full 1" throw
- Slam-locking with automatic mechanical deadlock
- Roller-type deadlock actuator
- Lock status switch indicates deadlocked latchbolt
- Keyed one or two sides
- Stainless Steel Strike/Keeper furnished with tamper resistant screws
- Quick connect electrical connectors
- Factory wired field-side pigtail
- RLB (Remote Latch Back)  
When unlocked, the latchbolt remains retracted until door is opened
- Plated and stainless steel parts

## STANDARD OPERATION

- Latchbolt retracts when power is applied to the lock and remains retracted until the door is opened approximately 2". Door relocks when closed.
- Provides automatic deadlocking, even in the event of a total loss of power.
- Fail secure, unlocks when energized.



2511 Midpark Rd., Montgomery, AL 36109  
Phone: (800) 466-3007 Fax: (334) 286-6421



# TECHNICAL SPECIFICATIONS

9924

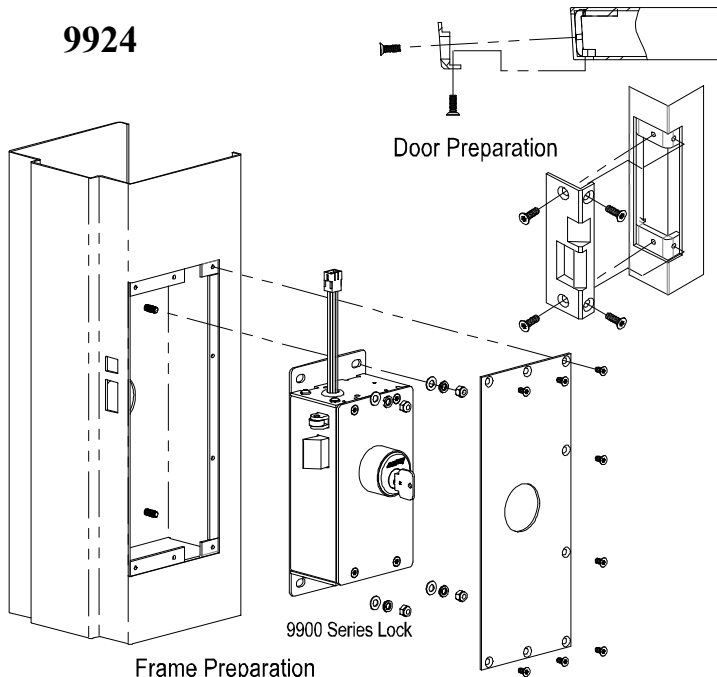

- **Body:** All steel construction
- **Dimensions:** 12"H x 5 7/16W x 3 1/2"D
- **Latchbolt:** Hardened Stainless Steel
- **Latchbolt Throw:** 1" - Flush when retracted
- **Deadlock Actuator:** Roller type, stainless steel
- **Lock Status Switch:** 15 amp rated, UL recognized
- **Electrical Power Consumption:** 24VDC, 3.5 amp inrush, 0.32 amp running
- **Electrical Connector:** Quick Connect electrical plug
- **Strike/Keeper:** Hardened Stainless Steel with pin-torx screws
- **UL10B:** 3 hour fire rating (see fire rating exceptions on cover page)
- **ASTM F 1577 Grade 1 Certified**

Note: Drawing for illustration only. Reference template for specific information

## HOW TO SPECIFY AND ORDER AN AIRTEQ 9924 LOCK

WHEN SPECIFYING ...						ALSO SPECIFY...										
MODEL NO.	X	"K1" OR "K2"	X	FINISH	X	SCREW HEAD STYLE	X	OPTIONAL FEATURES								
* WHEN ORDERING ...																
MODEL NO.	X	SWING CODE	X	CYL. TYPE & MFR.	X	FRAME CONDITION	X	FINISH	X	SCREW HEAD STYLE	X	OPTIONAL FEATURES	X	JAMB DEPTH (WHERE REQ.)	X	DOOR THK.
EXAMPLE A: SPECIFICATION READS... "KEYED 1 SIDE, MOGUL CYLINDER & KEY SWITCH"																
WHEN SPECIFYING ...																
9924 X K1 X US32D X TORX X KS																
* WHEN ORDERING ...																
9924 X 13 X AIRTEQ MOGUL X FR. POCKET X US32D X TORX X KS X 2"DR.																
EXAMPLE B: SPECIFICATION READS... "KEYED 2 SIDES, CYLINDER EXTENSION & NO LATCHBACK REQUIRED"																
WHEN SPECIFYING ...																
9924 X K2 X US32D X TORX X KCE X NRLB																
* WHEN ORDERING ...																
9924 X 08 X ASSA MOGUL X KCE X US32D X TORX X NRLB X 9"JD X 2"DR.																
* TEMPLATE NO. AND LATEST REVISIONS SHOULD BE COORDINATED WITH THE DOOR AND FRAME MANUFACTURER																

## SWING/HAND CHART

SWING CODE	DOOR HAND DIAGRAM * is COVER PLATE SIDE	SWING CODE	DOOR HAND DIAGRAM * is COVER PLATE SIDE
07 LHRB		08 RHRB	
09 RH		10 LH	
11 LHRB		12 RHRB	
13 RH		14 LH	

### Optional Features

- ◆ **KR** - Knob Release: Latchbolt is retracted by knob release on one side of lock. Knob is always active. When ordering, specify hinge side (HS) or stop side (SS).
- ◆ **KCE** - Key Cylinder Extension: Recommended for locks keyed stop side or keyed two sides.

### Optional Functions

- ◆ **NRLB** - No Remote Latch Back: Latch bolt extends immediately when power is removed or key is moved to the locked position.
- ◆ **KS** - Key Switch: Door is electrically unlocked by key operated switch at the lock. Can be disabled by the control system.
- ◆ **LEK** - Local Electric Key Switch: Provides for one key which operates lock electrically only, while higher level keys will operate it both mechanically and electrically. Includes 'KS' function plus a special function key cylinder.
- ◆ **KLHB** - Key operated Latch Hold Back: Latch is retracted locally by key and remains mechanically retracted until relocked by key.
- ◆ **ELHB** - Emergency Latch Hold Back: Latch bolt is retracted remotely and remains mechanically retracted until relocked at the door by key
- ◆ **RLHB** - Remote Latch Hold Back: Latch bolt is retracted by unlock control signal and remains retracted until lock receives a relock control signal. RLHB is typically combined with NRLB

**NOTE: PLEASE CONTACT AIRTEQ WHEN MORE THAN ONE FUNCTION IS REQUIRED ON THE SAME LOCK.**

### Warranty

Airteq warrants its products against defects in material or workmanship for one year from the time of delivery. Airteq's sole obligation under the warranty is to repair, or at its option, to replace the product. The buyer shall have no other remedy. (All special, incidental and coincidental damages are excluded.) Written notice of breach of warranty must be given to Airteq within the warranty period. The warranty does not cover damages resulting from improper installation or maintenance, accident or misuse. NO OTHER WARRANTIES AS TO MERCHANTABILITY OR OTHERWISE ARE MADE. A continuing product research program is ongoing. Airteq reserves the right to incorporate products and specification changes at any time without notice.

# SOLENOID LOCK 9912S



The **9912S** provides for electric or manual locking / unlocking of swinging doors. It can be operated from a remote location or by key at the door. For additional security, it is recommended that the 9912S lock be used with an Airteq high security door position sensor. An automatic door closer may also be used.

## APPLICATION:

Swing door lock for entrances, safety vestibules, corridors, inmate housing. Suitable for exterior locations.

## SECURITY LEVEL:

ASTM F 1577 Grade 1

## KEY CYLINDER:

Mogul cylinder or builders key cylinder with mogul sleeve (sold separately).

## MOUNTING:

Jamb mounted with either hinge side or stop side access cover.

## FIRE RATING:

UL10B - 3 Hour

(not available with these functions: KLHB & ELHB)

## STANDARD FEATURES

- Latch bolt has a full 1" throw
- Slam-locking with automatic mechanical deadlock
- Roller-type deadlock actuator
- Lock status switch indicates deadlocked latchbolt
- Keyed one or two sides
- Stainless Steel Strike/Keeper furnished with tamper resistant screws
- Quick connect electrical connectors
- Factory wired field-side pigtail
- Plated and stainless steel parts
- RLB (Remote Latch Back) When unlocked, the latchbolt remains retracted until door is opened

## STANDARD OPERATION

- Latchbolt retracts when power is applied to the lock and remains retracted until the door is opened approximately 2". Door relocks when closed.
- Provides automatic deadlocking, even in the event of a total loss of power.
- Fail secure, unlocks when energized.



2511 Midpark Rd., Montgomery, AL 36109  
Phone: (800) 466-3007 Fax: (334) 286-6421



Revised 12/01/2020



# TECHNICAL SPECIFICATIONS

9912S

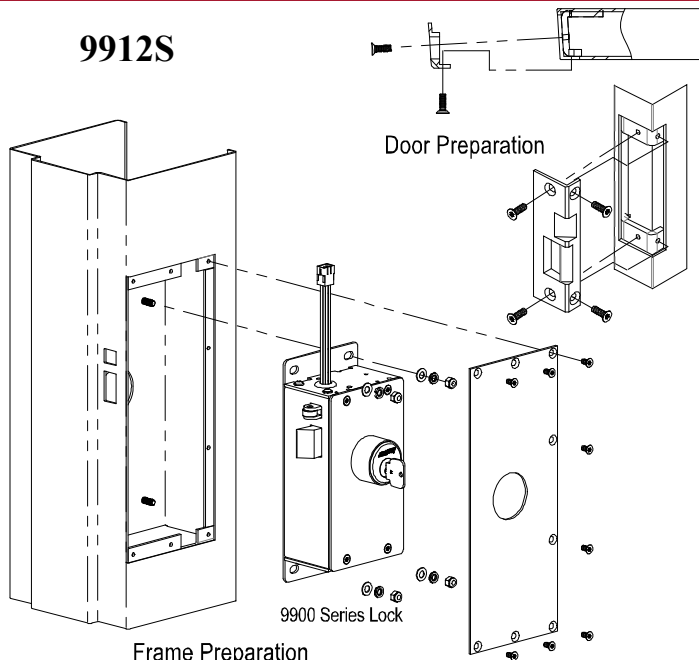

- **Body:** All steel construction
- **Dimensions:** 12"H x 5 7/16W x 3 1/2"D
- **Latchbolt:** Hardened Stainless Steel
- **Latchbolt Throw:** 1" - Flush when retracted
- **Deadlock Actuator:** Roller type, stainless steel
- **Lock Status Switch:** 15 amp rated, UL recognized
- **Electrical Power Consumption:** 115 VAC, 1 Phase, 60 Hz  
10 amp inrush, 0.6 amp seated
- **Electrical Connector:** Quick Connect electrical plug
- **Strike/Keeper:** Hardened Stainless Steel with pin-torx screws
- **UL10B:** 3 hour fire rating (see fire rating exceptions on cover page)
- **ASTM F 1577 Grade 1 Certified**

Note: Drawing for illustration only. Reference template for specific information

## HOW TO SPECIFY AND ORDER AN AIRTEQ 9912S LOCK

WHEN SPECIFYING . . .						ALSO SPECIFY...										
MODEL NO.	X	"K1" OR "K2"	X	FINISH	X	SCREW HEAD STYLE	X	OPTIONAL FEATURES								
* WHEN ORDERING . . .																
MODEL NO.	X	SWING CODE	X	CYL. TYPE & MFR.	X	FRAME CONDITION	X	FINISH	X	SCREW HEAD STYLE	X	OPTIONAL FEATURES	X	JAMB DEPTH (WHERE REQ.)	X	DOOR THK.
EXAMPLE A: SPECIFICATION READS . . ."KEYED 1 SIDE, MOGUL CYLINDER & KEY SWITCH"																
WHEN SPECIFYING . . .																
9912S X K1 X US32D X TORX X KS																
* WHEN ORDERING . . .																
9912S X 13 X AIRTEQ MOGUL X FR. POCKET X US32D X TORX X KS X 2"DR.																
EXAMPLE B: SPECIFICATION READS . . ."KEYED 2 SIDES, CYLINDER EXTENSION & NO LATCHBACK REQUIRED"																
WHEN SPECIFYING . . .																
9912S X K2 X US32D X TORX X KCE X NRLB																
* WHEN ORDERING . . .																
9912S X 08 X ASSA MOGUL X KCE X US32D X TORX X NRLB X 9"JD X 2"DR.																
* TEMPLATE NO AND LATEST REVISIONS SHOULD BE COORDINATED WITH THE DOOR AND FRAME MANUFACTURER																

## SWING/HAND CHART

SWING CODE	DOOR HAND DIAGRAM * is COVER PLATE SIDE	SWING CODE	DOOR HAND DIAGRAM * is COVER PLATE SIDE
07 LHRB		08 RHRB	
09 RH		10 LH	
11 LHRB		12 RHRB	
13 RH		14 LH	

### Optional Features

- ◆ **KR** - Knob Release: Latchbolt is retracted by knob release on one side of lock. Knob is always active. When ordering, specify hinge side (HS) or stop side (SS).
- ◆ **KCE** - Key Cylinder Extension: Recommended for locks keyed stop side or keyed two sides.

### Optional Functions

- ◆ **NRLB** - No Remote Latch Back: Latch bolt extends immediately when power is removed or key is moved to the locked position.
- ◆ **KS** - Key Switch: Door is electrically unlocked by key operated switch at the lock. Can be disabled by the control system.
- ◆ **KLHB** - Key operated Latch Hold Back: Latch is retracted locally by key and remains mechanically retracted until relocked by key.
- ◆ **ELHB** - Emergency Latch Hold Back: Latch bolt is retracted remotely and remains mechanically retracted until relocked at the door by key

**NOTE: PLEASE CONTACT AIRTEQ WHEN MORE THAN ONE FUNCTION IS REQUIRED ON THE SAME LOCK.**

### Warranty

Airteq warrants its products against defects in material or workmanship for one year from the time of delivery. Airteq's sole obligation under the warranty is to repair, or at its option, to replace the product. The buyer shall have no other remedy. (All special, incidental and coincidental damages are excluded.) Written notice of breach of warranty must be given to Airteq within the warranty period. The warranty does not cover damages resulting from improper installation or maintenance, accident or misuse. NO OTHER WARRANTIES AS TO MERCHANTABILITY OR OTHERWISE ARE MADE. A continuing product research program is ongoing. Airteq reserves the right to incorporate products and specification changes at any time without notice.

## SECTION 11 19 10

### SURFACE MOUNTED LOCK HOUSING ASSEMBLIES

#### PART 1 – GENERAL

##### 1.1 RELATED DOCUMENTS

- A. Drawings and general provisions of the Contract, including General Conditions and Division 1, as well as Section 11 19 00, Detention Equipment, apply to this Section.
- B. See Drawings

##### 1.2 SUMMARY

- A. General
  - 1. This section consists of providing the Surface-Mounted Lock Pocket Assemblies required to complete the work.
  - 2. The specification together with the drawings and schedules cover the required units.
- B. Work includes, but is not limited to: furnishing the security hardware and specific finish hardware as shown on the drawings and described in these specifications, including but not limited to the following components:
  - 1. Detention security hollow metal retro-fit lock pocket including retro-fit door strike.
    - a. Provide configurations of Housings as shown to include Single (Left/Right); Double; and Special (as required)
  - 2. Detention Lock, Hardware and accessories
  - 3. Closure cover plates for existing door strike and lock faceplate.
  - 4. High intensity door status LED with guard assembly
  - 5. Security features in the design of the assembly that protect the lock bolt from “sheeting” or “popping”
- C. Related work specified elsewhere includes, but is not limited to:
  - 1. Section 11 19 00, Detention Equipment -General

##### 1.3 PERFORMANCE REQUIREMENTS

- A. Detention Lock Housing Assemblies: Provide assemblies that exceed requirements of security Grade 1, when tested according to ASTM F1450 -12A double the amount of impacts to 1,200. Based on testing manufacturer's standard units in assemblies like those indicated for this Project.

##### 1.4 QUALITY ASSURANCE

- A. Manufacturer's Qualification
  - 1. Subject to the requirements of the bid documents, the following manufacturers are pre-approved to perform work in this section:

##### **\*BASIS OF DESIGN**

a. Airteq Systems, Montgomery, AL

**B. Installer's Qualification**

1. Installer shall receive special training from Manufacturer on how to install and adjust the special lock pocket. This training shall be done either at the Manufacturer's facility or at the job site and must be completed prior to or at the time of first installation of the new lock pockets. The installing company shall have a minimum of one representative designated as the Certified Installer and this individual shall be the one trained and the one responsible for training all other personnel within that company who will be installing the new lock pocket and lock at the project.
2. Manufacturer shall provide the Certified Installer with a certificate designating him/her as a qualified installer for this product.

**1.5 WARRANTY**

- A. All work shall be warranted from defects in workmanship and quality for a period of Two (2) years from date of installation.

**1.6 SUBMITTALS**

- A. Product Data: Submit Manufacturer's technical product data for each item of finish hardware. Show compliance with requirements and include instructions for installation and for maintenance of operating parts and finish.
- B. Samples
- C. Shop Drawings
1. Submit Shop Drawings showing quality, type, and location of security hardware.
    - a. Wiring Diagrams: Detail power, signal, and control wiring and differentiate between manufacturer-installed and field-installed wiring for electrified detention door hardware. Include the following:
      - 1) System schematic.
      - 2) Point-to-point wiring diagram, including location of connections.
      - 3) Riser diagram.
      - 4) Elevation of each detention door.
  2. Provide layouts for each unique condition / hosing configuration:
    - a. Single Housing (Left and right hands)
    - b. Double Housing
    - c. Special Housing (as required)

**1.7 PRODUCT DELIVERY, STORAGE AND HANDLING**

- A. Tag each item or package separately, with identification related to the Hardware Schedule, and include installation instructions. Deliver individually packaged hardware items at the proper times to the Shop or Project Site for installation.
- B. Delivery of Materials

1. Furnish finished product in such quantities and at such times so as not to delay the progress of the work.
2. Label or tag finish product for its intended use in such a manner that application will be easily understood. Label with set numbers according to the approved hardware schedule.

## **1.8 JOB CONDITIONS**

### **A. Field Service**

1. Supplier shall provide 3 separate site visits by a competent manufacturer's representative for keying meeting(s) and project coordination.

## **1.9 MAINTENANCE SERVICE**

### **B. Maintenance Tools and Instructions:** Furnish a complete set of specialized tools and maintenance instructions as needed for Owner's continued adjustment, maintenance, and removal and replacement of detention door hardware.

### **C. Tool Kit:** Provide six sets of tools for use with security fasteners, each packaged in a compartmented kit configured for easy handling and storage.



## PART 2 – PRODUCTS

### 2.01 Lock Housing Assemblies:

#### A. Basis of Design:

1. Airteq Defender.: Model SMH-1 or SMH-2.

#### B. Materials

1. Lock pocket and strike assembly shall be constructed of commercial quality, level, cold-rolled steel conforming to ASTM A 366 or hot-rolled, pickled and oiled steel conforming to ASTM A 569. The steel shall be free of scale, pitting, coil breaks or other surface blemishes. It shall also be free of buckles, waves or any other defects caused using improperly leveled sheets.
2. Interior assemblies: Shall be 12 gage or 10 gage as required to meet testing performance requirements defined in section 1.3.  
Note: For interior areas subject to corrosive conditions use zinc coated steel face sheets as specified in 2.01. A. 3.
3. For severely corrosive conditions and where specified on individual openings either interior or exterior, face sheets shall be stainless steel meeting ASTM A 666, Type 304

#### C. Construction

1. General:
  - a. All assemblies shall be of the types and sizes shown on the approved submittal drawings, shall be constructed in accordance with the specifications and shall meet the performance requirements of Section 1.3
  - b. Alternate methods of construction, which meet the performance criteria, shall be permitted.
  - c. Where required, face sheets shall be joined at their vertical edges by a continuous weld extending the full height of the assembly. See “continuously welded” in the Glossary of Terms for Hollow Metal Doors and Frames, HMMA 801. Edge welding shall be ground smooth with no visible seams. Metal filler used at the lock pocket edges is unacceptable.
  - d. All exposed fasteners of the lock pocket and strike assembly shall be Torx type fasteners with center reject pin. Quantity and positioning of fasteners shall be as needed to meet testing performance requirements defined in section 1.3.
  - e. Minimum height of formed stops in door openings shall be 7/8”.

#### D. Features Required for Officer and Inmate Safety and Liability

1. Prevent inmate from having access to the lock bolt from inside the cell by enclosing the lock bolt in an isolated cavity. This cavity shall extend the length of the lock bolt. This cavity must house the entire door strike assembly.
2. Design of the lock pocket shall prevent inmate from having access to the lock bolt from top, front or bottom while outside the cell.
3. Prevent the lock from being defeated by common methods (“sheeting” or “carding”) by pinching the material that prevents the lock bolt from extending and deadlocking. Lock bolt & door strike shall be fully enclosed in an isolated cavity to prevent this (“sheeting” or “carding”). A demonstration of this feature is required prior to approval of the product.
4. Design of the lock pocket shall prevent the inmate from slipping a sheet, card, paper or other foreign object from the top or bottom of the door and touching or engaging any part of the lock bolt or roller bolt. Demonstration is required prior to approval.
5. Design of the lock pocket shall make it virtually impossible to defeat the lock via “sheeting”, “carding” or other methods when the lock bolt is fully extended, and the lock pocket LED is indicating secure.
6. Prevent packing the strike to keep the lock from dead-locking.

7. Each Lock pocket assembly shall provide, within the assembly itself, one High-Intensity LED:
  - a. Secured condition (door closed and dead-locked): "Green" indication
  - b. All other unsecured conditions: "Red" indication.
  - c. "Green" and "Red" indications shall be clearly visible from secure side of door at all traffic directions and from the control room.
  - d. LED shall be High-Intensity, daylight visible, immune to EMI and RFI interference and with a rugged polycarbonate lens, 30 mm fully translucent dome, 24 VDC. Must be UL rated and meet IP65 rating.
  - e. LED shall meet specification IP65 (Totally protected against dust as well as protected from jets of water).

E. Features Required for Maintenance

1. Provide removable cover to allow for easy clean out of the strike pocket
2. Provide a heavy 12-gauge shield over the High-Intensity LED to protect it from vandalism from all angles. This shield shall prevent damage of the light by an object like a tooth brush handle or a ball point pen. This shield shall not prevent the light from being clearly visible from secure side of door at all traffic directions and from the control room.
3. The Lock Pocket shall be designed to allow maintenance to remove the lock cover and adjust the lock without removing the lock from the Lock Pocket.
4. The lock pocket will be designed to facilitate final alignment of the lock bolt with the strike opening.
5. The design shall incorporate a sloped top and bottom cover to prevent jumping on or prying against the lock pocket.
6. Closure plates and security screws for existing strikes, lock and DPS faceplates shall be provided by manufacturer and installed by the DEC.

F. Anchorage

1. The structural integrity of the existing wall must be maintained.
2. Lock pocket and strike assemblies shall be bolted into the wall and field welded to existing frame and door as required to meet test performance criteria in paragraph 1.06.
3. Lock Pocket assemblies shall be provided with factory-prepared holes in the backing plate to provide for the anchoring conditions on this project.
  - a. Where there are exposed perimeter field welds of box to frame and door, apply security caulk, continuous between welds. Caulk shall be pick-proof Pecora Dyna-Poxy or equal. Color to match lock pocket body.
  - b. Touch up paint for wall shall match existing wall and cover all exposed field welds and areas damaged by field welding or installation.

G. Hardware

1. Lock shall be an Airteq 9912M, 120 VC that has been ASTM tested with the lock pocket housing.
2. Door Position Switch shall be an Airteq 6200 DPS
3. Door Pull shall be made integral in the door receiver portion of the lock pocket.
4. Door Stop shall be an Airteq 650/651 and shall be mounted to the receiver portion of the Lock Housing.

H. Electrical

1. The existing door control and monitoring system (locking control panel) must remain intact and completely operational. When lock pocket installation is completed, the indicator LED on lock pocket shall accurately signal green for secure conditions and red for all unsecure conditions. Modifications may be required to the circuitry for the 24 VDC DPS and 24 VDC LED to work with the existing locking control panel.

2. Housing manufacturer shall provide internal wiring for all provided hardware. Hardware shall be provided with field connections that are coordinated with the existing Door Controls system and as required by Division 28.
  - a. One Wiring Harness shall be factory wired inside each lock pocket. This Wiring Harness shall have a standard connector so that the lock can be easily unplugged for testing with a test box. The mating pigtail shall be furnished for butt splicing to the field wires.
3. All new field wiring shall be #16 AWG stranded copper THHN. All wiring shall be clearly and specifically labeled and identified. Conductors routed to individual lock pockets shall be continuous from the remote electrical enclosure to the individual lock pocket. No common wiring shall be used for multiple locks.

#### **I. FINISH**

1. After fabrication, all tool marks and surface imperfections shall be filled and sanded as required to make face sheets, vertical edges and weld joints free from irregularities. After appropriate metal preparation, all surfaces shall be finish painted, inside and out, with an epoxy paint or durable polyester finish paint (Powder Coat). Color to be selected by the owner from manufacturer's standard color chart.
2. All weld burns and smoke damage done to the existing door or frame shall be primed and painted to blend with the existing paint.
3. All filler plates used behind the lock pocket to make it fit the frame and wall condition shall be security caulked between the filler plate and the wall and between the filler plate and the lock pocket.

#### **PART 3-EXECUTION**

##### **A. NOT USED**

# NUMERICAL DESIGNATION FOR DETERMINING HANDING OF AIRTEQ LOCKS

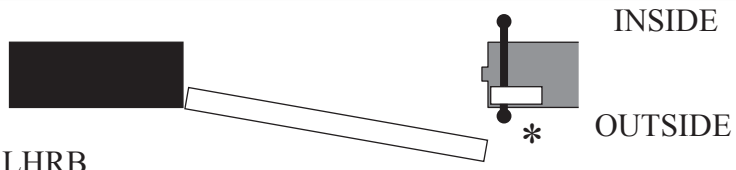
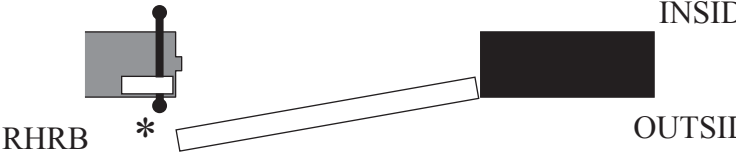
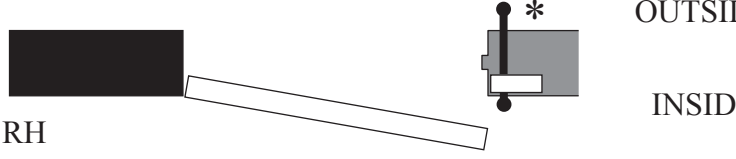
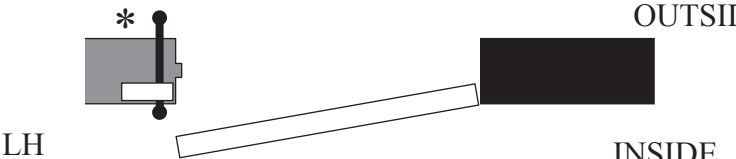
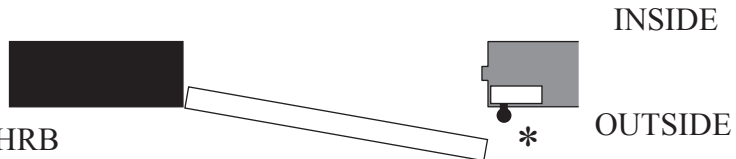
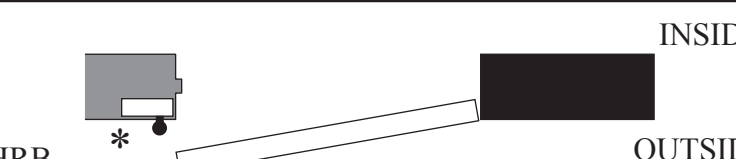
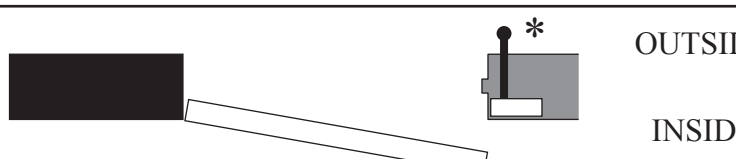
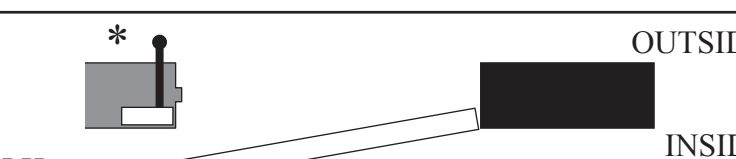
<b>9900 SERIES LOCKS</b>		
<b>LOCK KEYED BOTH SIDES</b> <b>COVER PLATE HINGE SIDE</b>	SWING CODE DESIGNATION  <b>07</b>	 <p style="text-align: center;">LHRB</p>
<b>LOCK KEYED BOTH SIDES</b> <b>COVER PLATE HINGE SIDE</b>	<b>08</b>	 <p style="text-align: center;">RHRB</p>
<b>LOCK KEYED BOTH SIDES</b> <b>COVER PLATE STOP SIDE</b>	<b>09</b>	 <p style="text-align: center;">RH</p>
<b>LOCK KEYED BOTH SIDES</b> <b>COVER PLATE STOP SIDE</b>	<b>10</b>	 <p style="text-align: center;">LH</p>
<b>LOCK KEYED HINGE SIDE</b> <b>COVER PLATE HINGE SIDE</b>	<b>11</b>	 <p style="text-align: center;">LHRB</p>
<b>LOCK KEYED HINGE SIDE</b> <b>COVER PLATE HINGE SIDE</b>	<b>12</b>	 <p style="text-align: center;">RHRB</p>
<b>LOCK KEYED STOP SIDE</b> <b>COVER PLATE STOP SIDE</b>	<b>13</b>	 <p style="text-align: center;">RH</p>
<b>LOCK KEYED STOP SIDE</b> <b>COVER PLATE STOP SIDE</b>	<b>14</b>	 <p style="text-align: center;">LH</p>

\* INDICATES LOCK COVER PLATE SIDE.





**AIRTEQ**  
www.airteq.com  
800-466-3007

# Defender Full Frame

7/2/2020

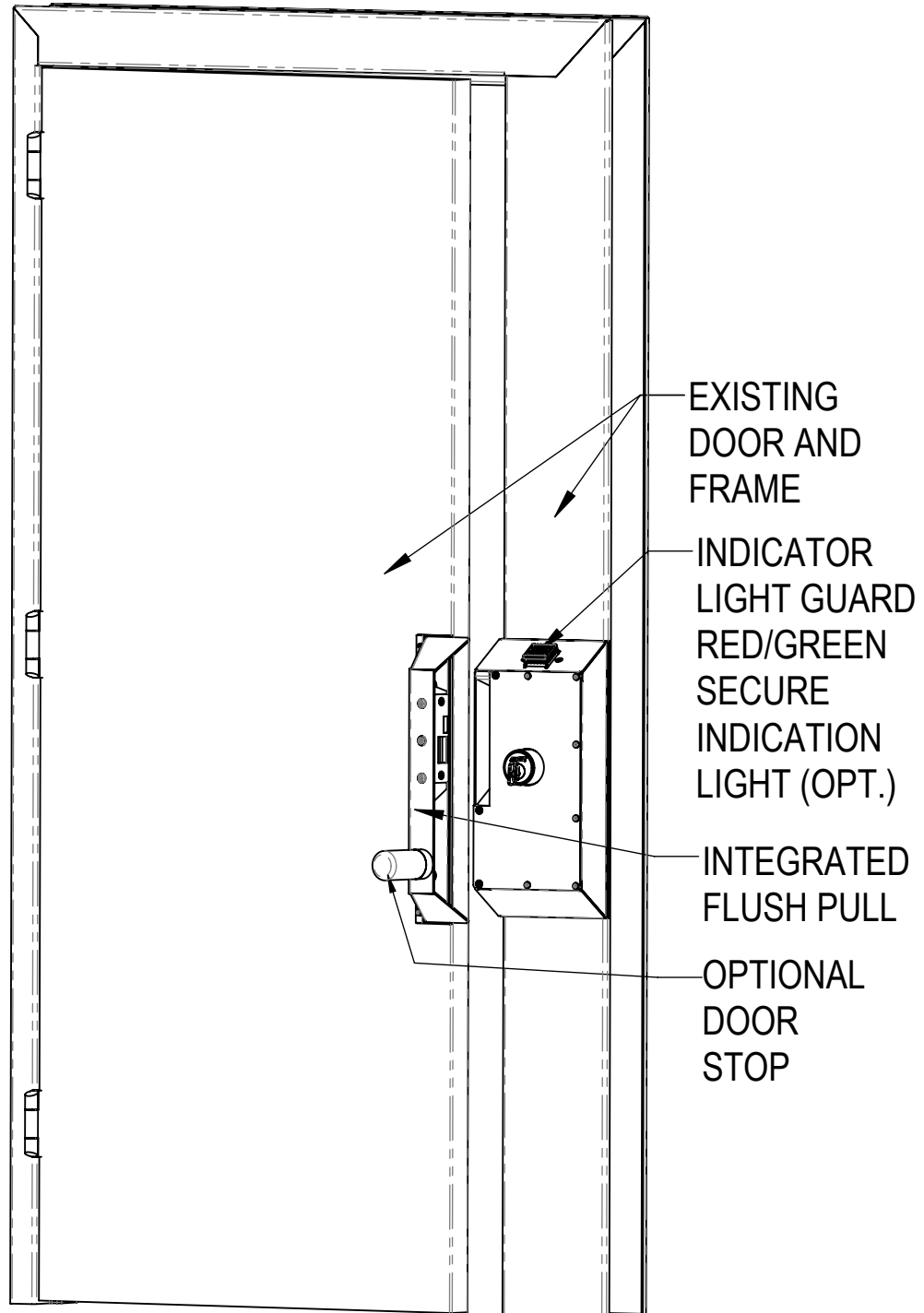



**AIRTEQ**  
www.airteq.com  
800-466-3007

## Defender Layout

7/2/20

Each opening receives the following:

1. New Surface Mounted Lock Box
2. Airteq 9900 Lock
3. Airteq 6200DPS (optional)
4. Red/Green Indication LED w/Guard (optional)
5. Integrated Flush Pull
6. Door Stop (optional)

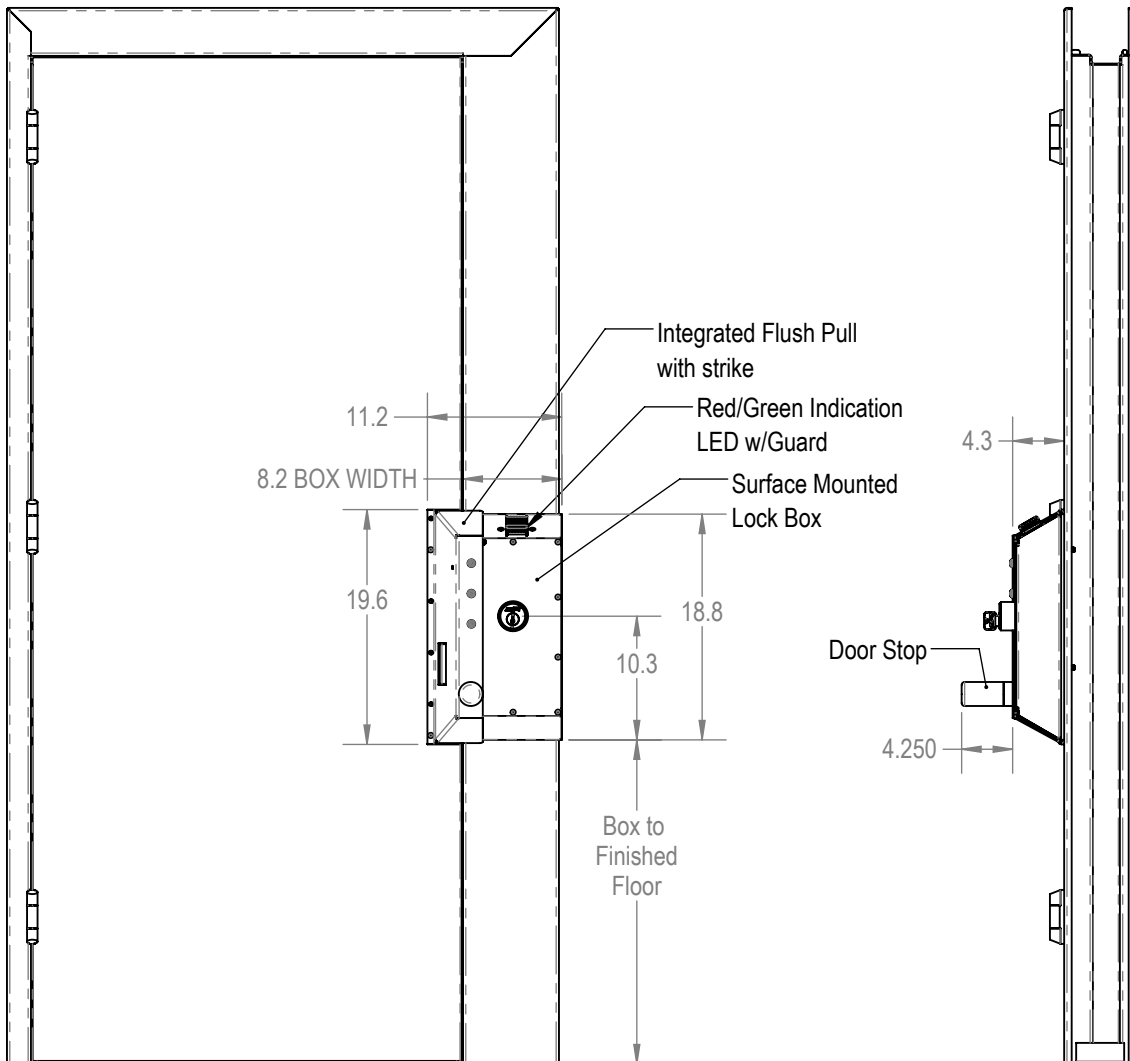
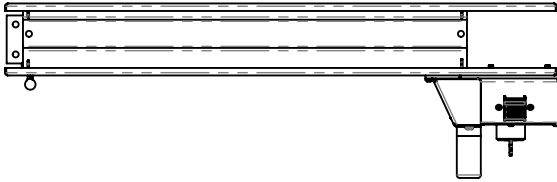

Right hand door shown, left hand opposite



**AIRTEQ**  
www.airteq.com  
800-466-3007

## DEFENDER FRONT VIEW

7/2/20



## DEFENDER ISO VIEWS

7/2/20

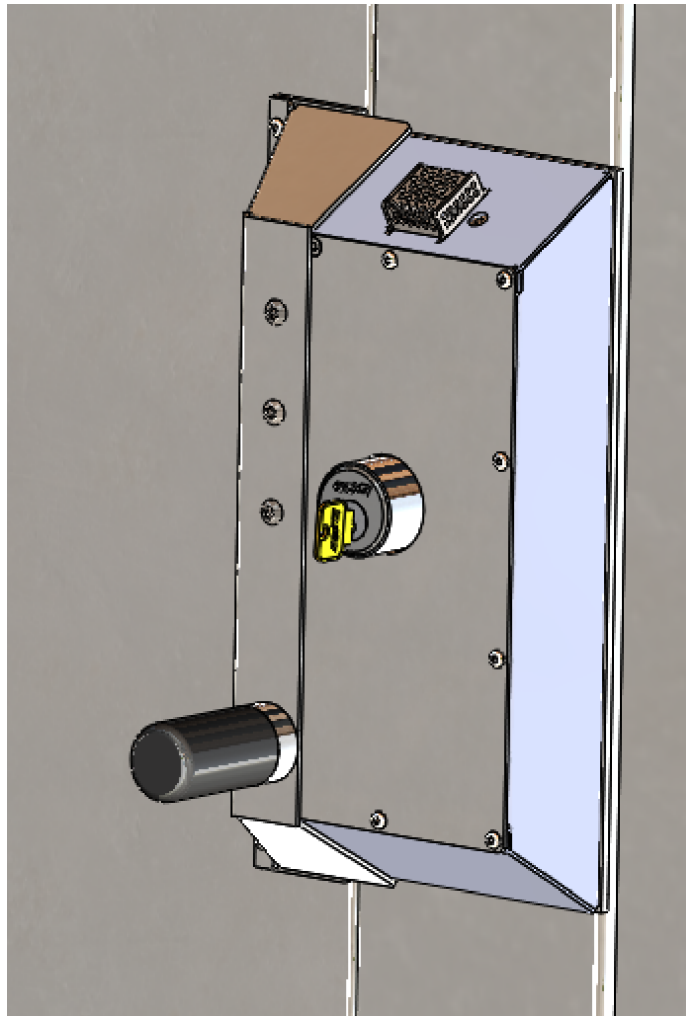



## DEFENDER DOOR OPEN

7/2/20

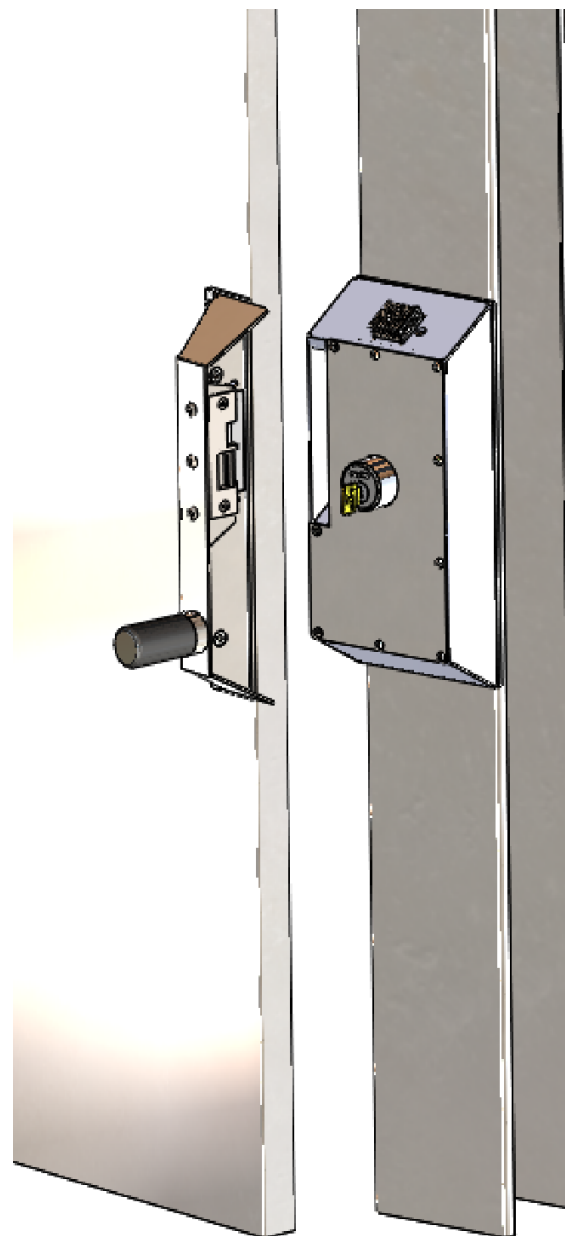
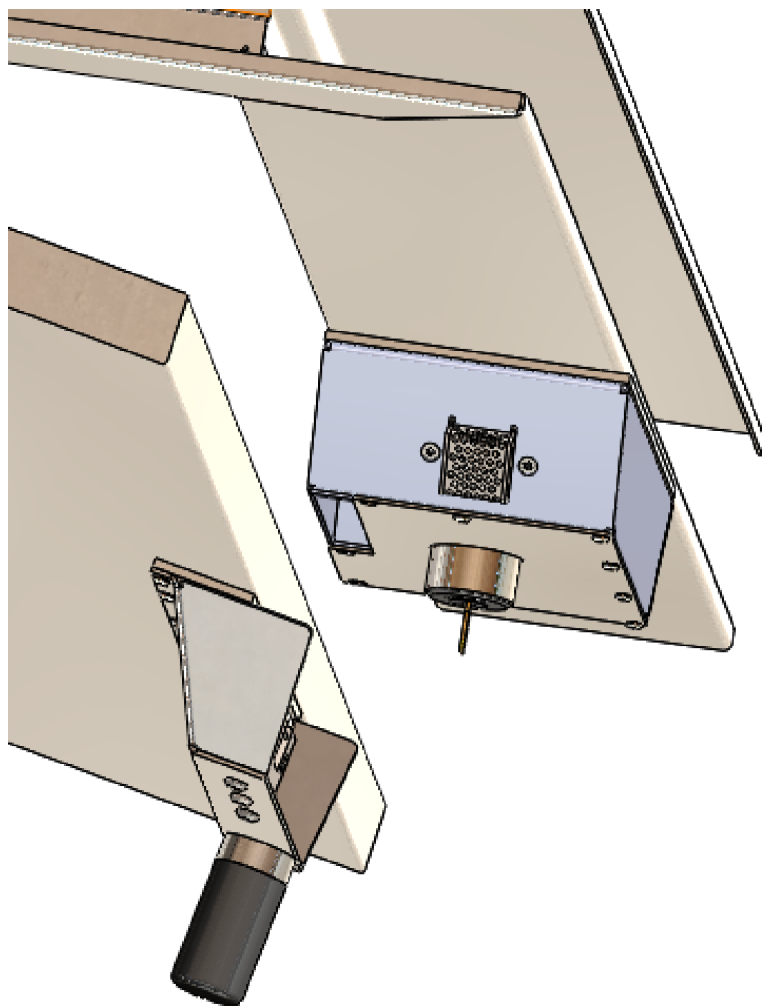

## DEFENDER DOOR OPEN

7/2/20

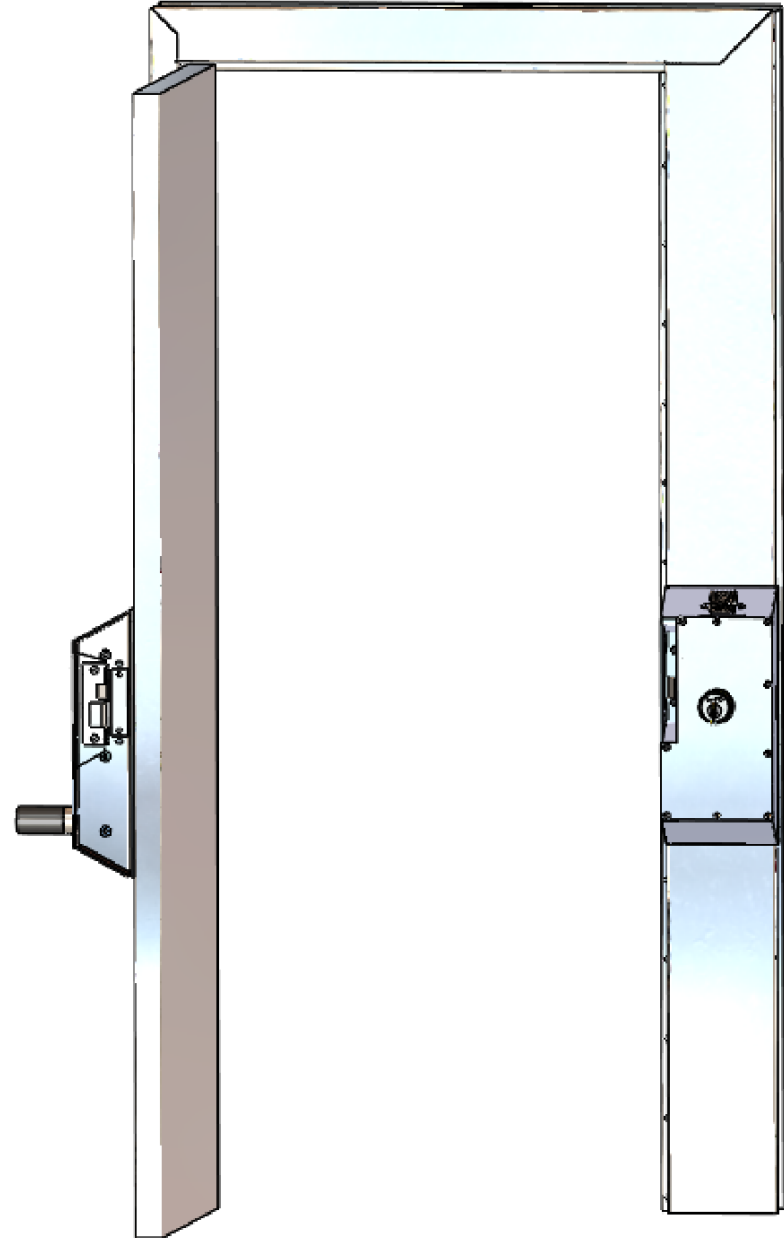
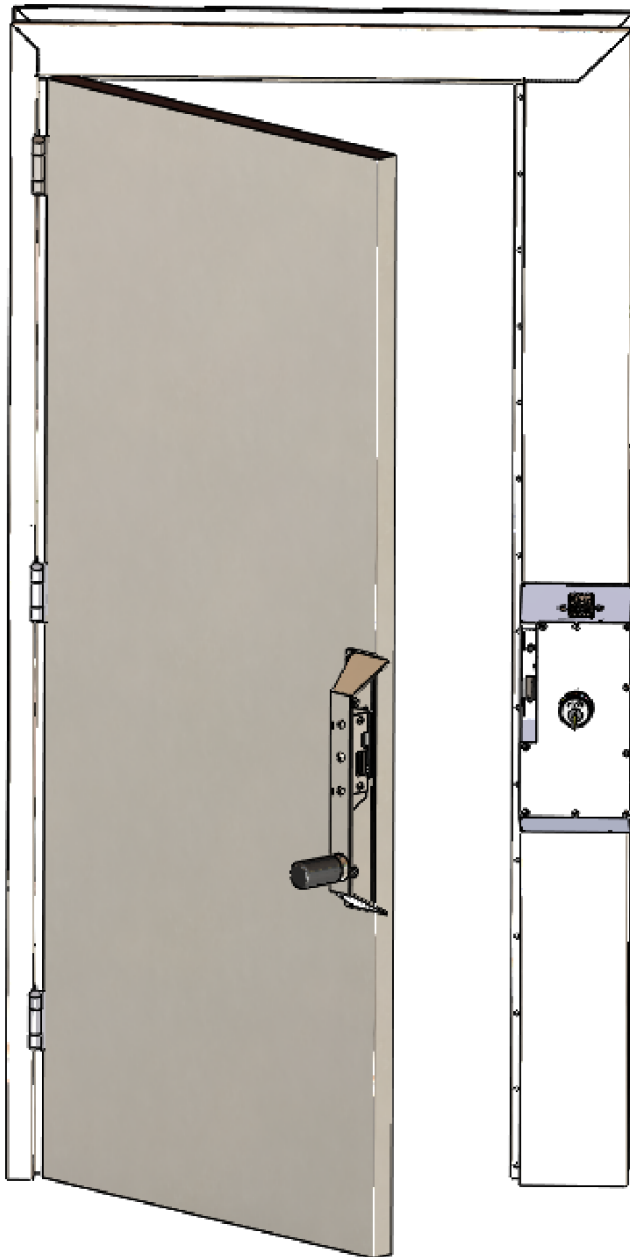

## DEFENDER STRIKE VIEW

7/2/20

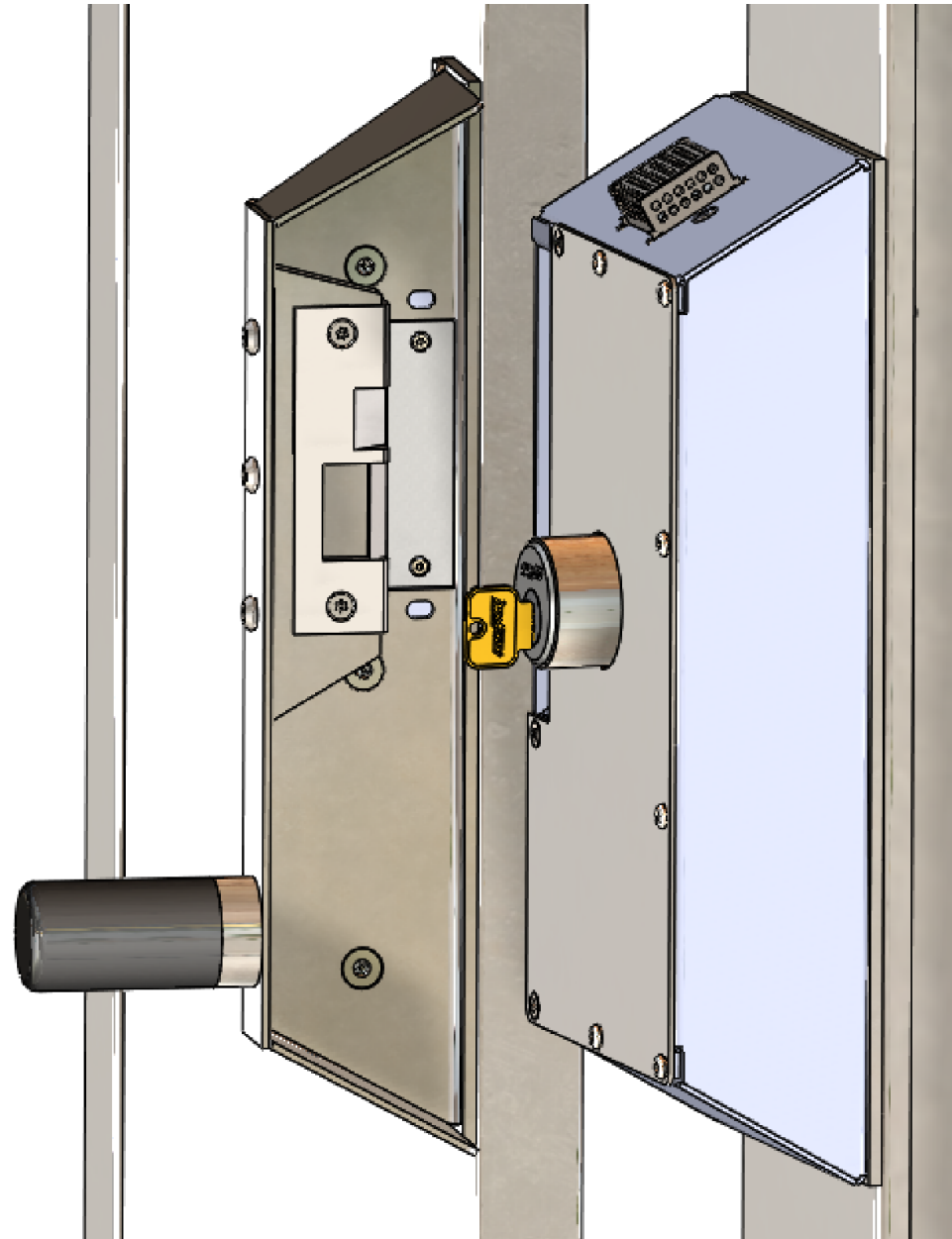

## DEFENDER EXPLODED VIEW

7/2/20

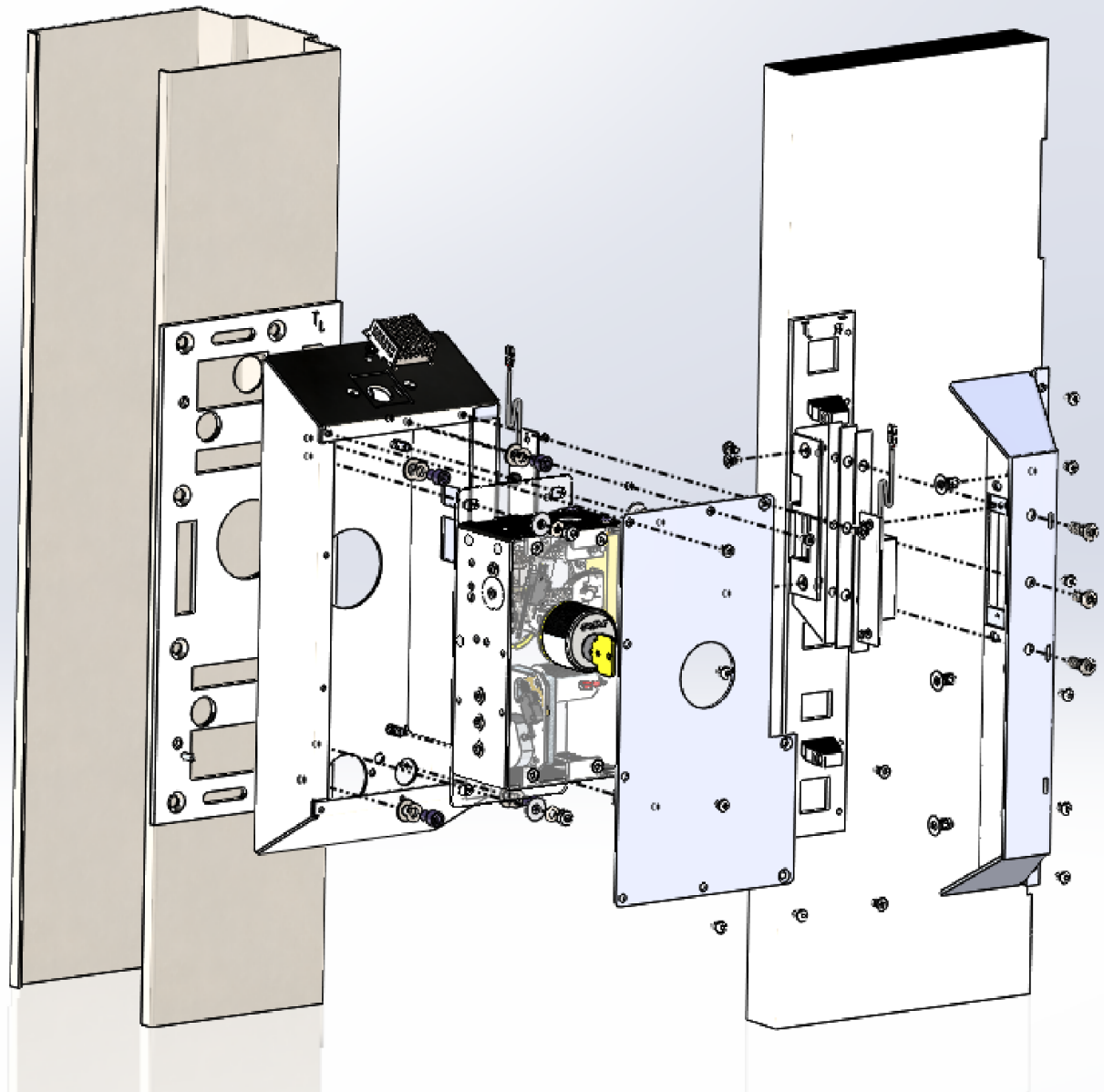



REVISIONS				
REV	ECN	DESCRIPTION	DRAWN	CHK

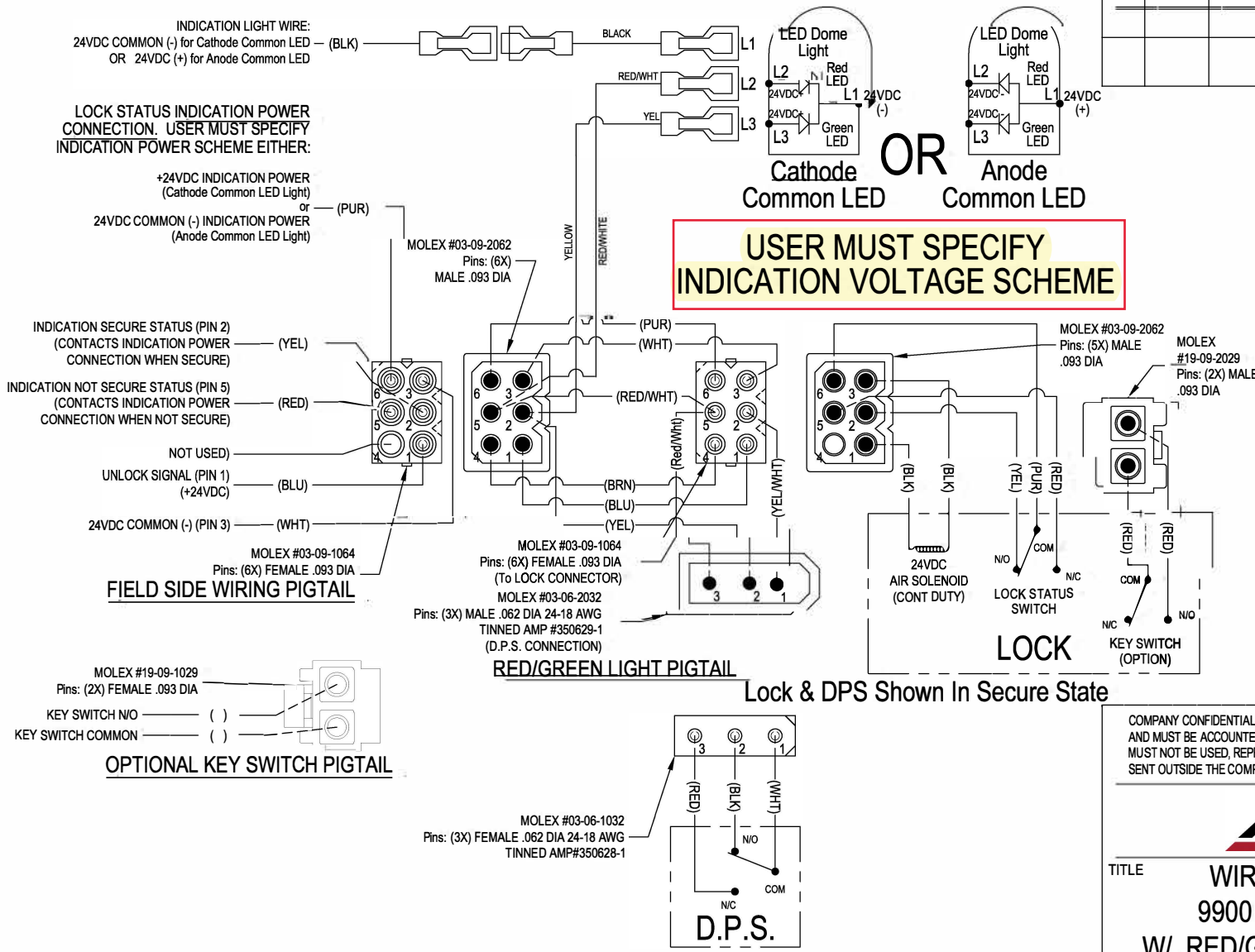

- NOTES:
- AIR SOLENOID LOAD: 24VDC ±2V, 1.5W MAX
  - SWITCH CONTACTS: 5A.
  - SCHEMATIC SHOWN WITH DOOR IN THE CLOSED AND LOCKED (SECURE) POSITION.
  - PLUGS AND RECEPTACLES INSIDE LOCK NOT SHOWN.
  - LOCK INDICATION POWER CIRCUIT IS 24VDC. HOWEVER, USER MUST SPECIFY CATHODE COMMON OR ANODE COMMON INDICATION SCHEME AS SHOWN.
  - LOCK ACTIVATION POWER IS 24VDC ±2V
  - SUPPLYING 120VAC TO INDICATION CIRCUIT WILL CAUSE CATASTROPHIC FAILURE OF INDICATION COMPONENTS
  - ALWAYS INSTALL IN ACCORDANCE WITH LOCAL REGULATIONS AND THE NATIONAL ELECTRIC CODE (NEC).
  - GROUND LOCK CASE IN ACCORDANCE WITH ARTICLE 250 OF THE NATIONAL ELECTRICAL CODE

COMPANY CONFIDENTIAL: THIS DRAWING IS THE PROPERTY OF AIRTEQ SYSTEMS AND MUST BE ACCOUNTED FOR. INFORMATION HEREON IS CONFIDENTIAL AND MUST NOT BE USED, REPRODUCED, REVEALED TO UNAUTHORIZED PERSONS OR SENT OUTSIDE THE COMPANY WITHOUT PROPER AUTHORIZATION.



TITLE <b>WIRING DIAGRAM</b> 9900 24VDC Air Lock W/ RED/GREEN LIGHT (niv.)	DRAWN BY RLP
	APPROVED
	DATE 10/24/18
SCALE NONE	
©1989 AIRTEQ SYSTEMS.	SIZE DWG. NO. REV B EL-9900-RGL-U A

### COMPACT DEFENDER BOX ASSEMBLY WITH DOOR STOP

6/30/20

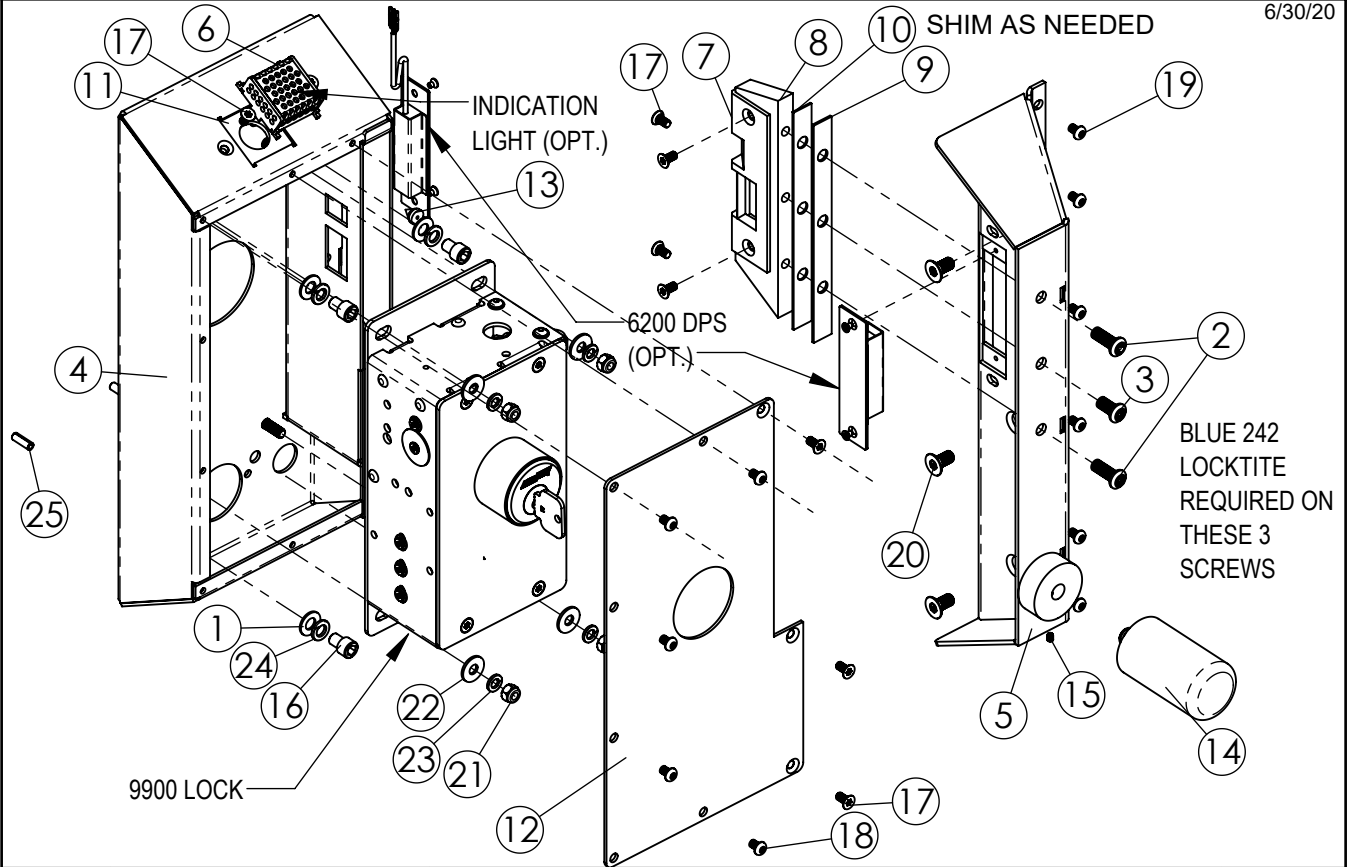

ITEM NO.	PART NUMBER	DESCRIPTION	QTY
1	10000708	WASHER, FLAT, 3/8 SAE, ZP	4
2	10003401S	SCREW BHMS 3/8-16x1 T45 PIN TORX, Stainless Steel	2
3	10003407S	SCREW BHMS 3/8-16x3/4 T45 PIN TORX, Stainless Steel	1
4	150-99DF-SD1-LH-C	COMPACT DEFENDER BOX WELDMENT, LH	1
5	150-99DF-SD3-LH-DS	DEFENDER SHROUD AND PULL, LH, WITH DOOR STOP	1
6	150-99DF-SD6	INDICATOR LIGHT GUARD WELDMENT	1
7	216-9900-260L	9900 Strike Plate LH / RHRB	1
8	216-99DF-SD5	DEFENDER SHROUD STRIKE	1
9	216-99DF-SD5-S14	14 GA SHIM FOR SHROUD STRIKE	1
10	216-99DF-SD5-S16	16 GA SHIM FOR SHROUD STRIKE	1
11	216-99DF-SD6-LG-BP	BACKUP PLATE FOR LIGHT GUARD	1
12	216-99DF-SDC-LH	DEFENDER BOX COVER, LC	1
13	216-99DF-SR64	SR 64 DOOR SILENCER	2
14	217-0000-017-D	650 DOOR STOP FOR DEFENDER BOX	1
15	310-1032-014	SET SCREW, 10-32 X .25	1
16	310-3816-033	SCREW, SHCS 3/8-16 X .500 WITH LOCKING PATCH	4
17	311-2520-082	Screw, FH, Pin TORX, 1/4-20x1/2, Stainless Steel, UC Head	9
18	311-2520-108	Screw, TP, BH Torx 1/4-20x3/8 SS	6
19	311-2520-114	Screw, TP, BH Torx PLUS 1/4-20x3/8 SS	6
20	311-3816-008	Screw FH pin TORX 3/8-16x .75" Zinc Plated	3
21	312-3118-000	NYLOCK NUT, 5/16-18	4
22	313-0000-002	WSHR FLAT 5/16 TYPE B REG STL PLT	4
23	313-0000-004	Washer, Split Lock, 5/16, Steel, Zinc Plated	4
24	313-0000-115	Washer Lock split spring 3/8 Zinc Plated	4
25	316-9900-030	Slotted Steel Spring Pin, 1/4ODx3/4 Length, McMaster 98296A924 or eq.	2



**AIRTEQ**

www.airteq.com  
800-466-3007

## **PILASTER DEFENDER**

7/2/20

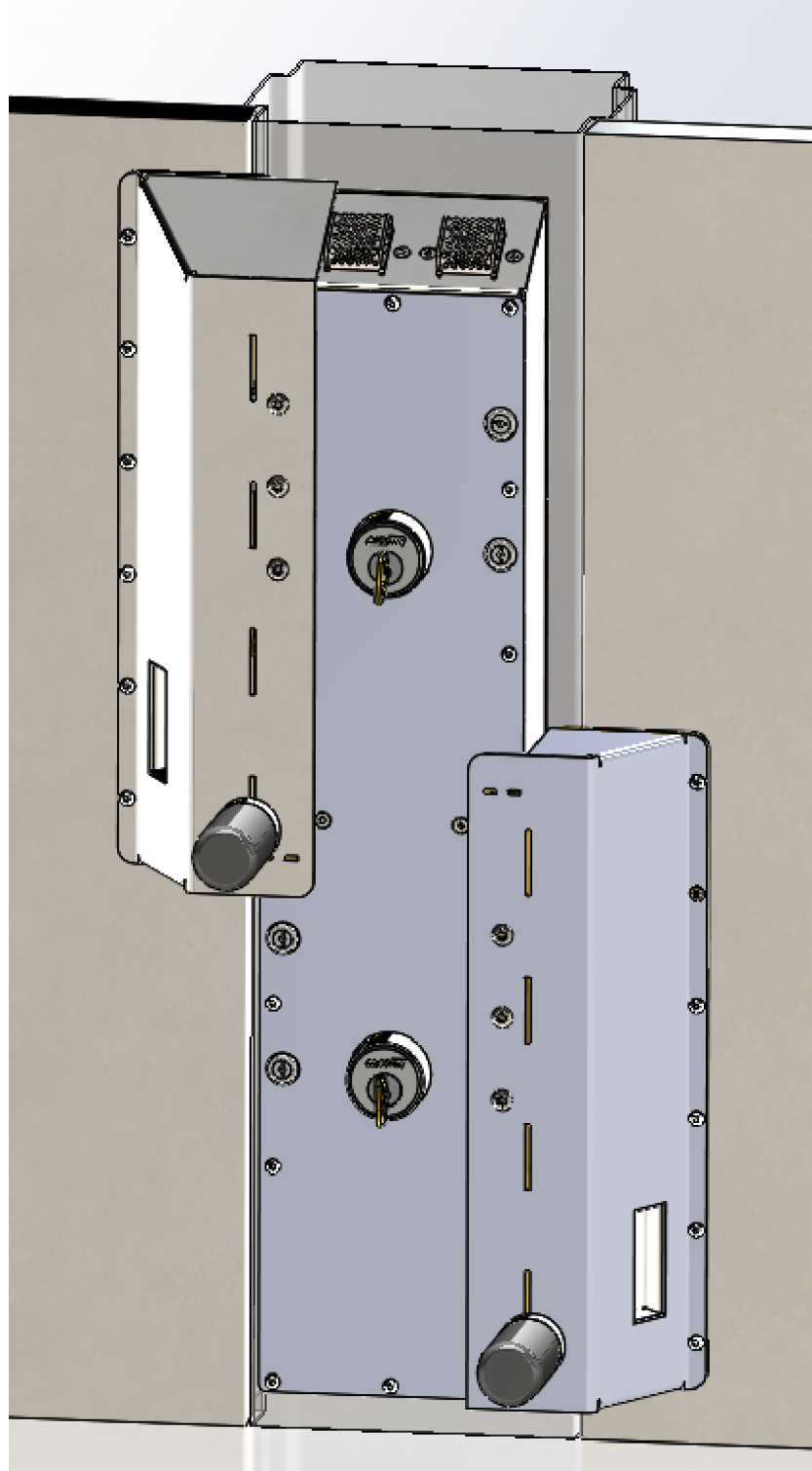



**AIRTEQ**  
www.airteq.com  
800-466-3007

# PILASTER DEFENDER

5/20/20

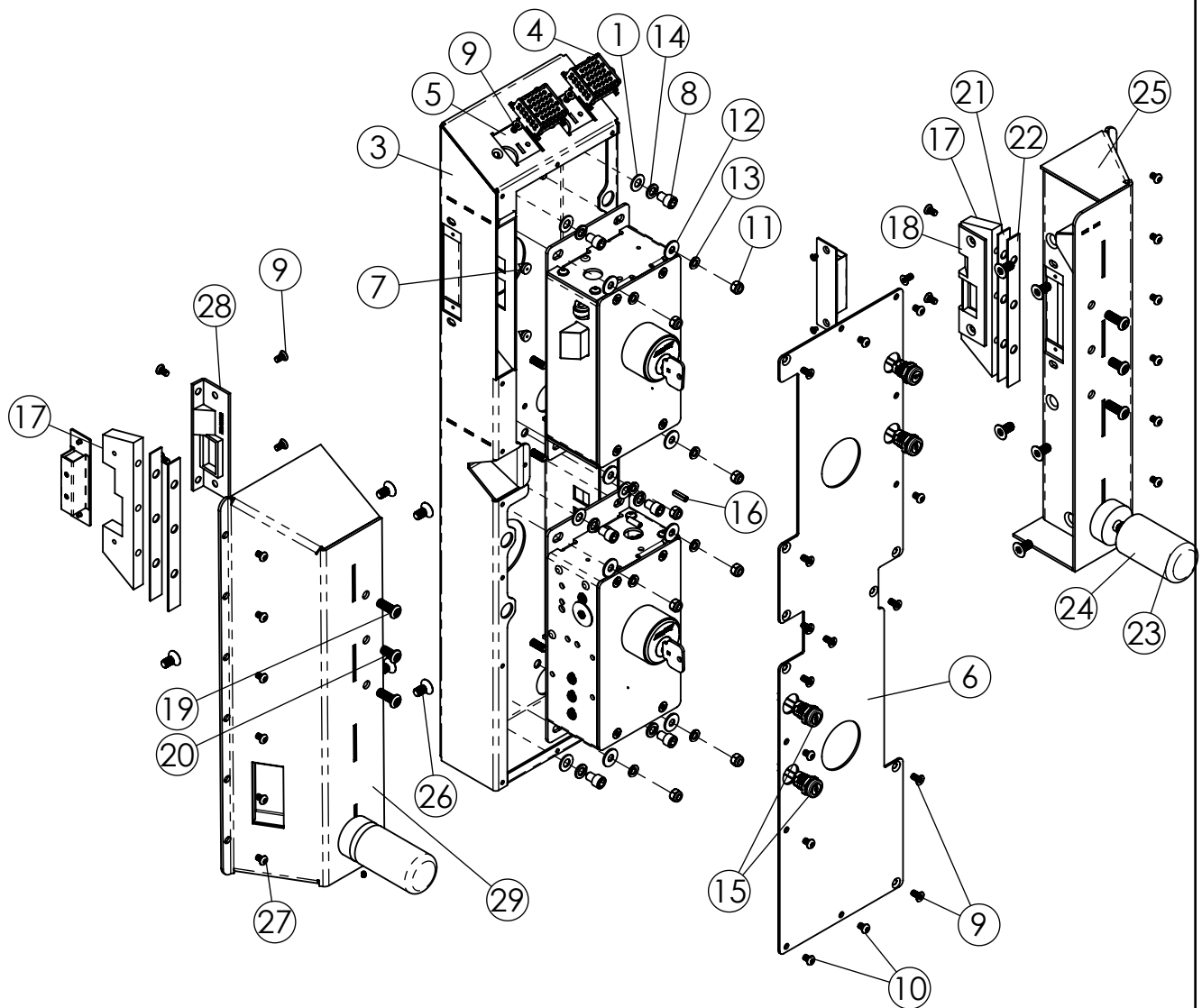

**AIRTEQ**

www.airteq.com

800-466-3007

**PILASTER DEFENDER**

5/20/20

ITEM NO.	PART NUMBER	DESCRIPTION	QTY
1	10000708	WASHER, FLAT, 3/8 SAE, ZP	6
2	10003401S	SCREW BHMS 3/8-16x1 T45 PIN TORX, Stainless Steel	4
3	10003407S	SCREW BHMS 3/8-16x3/4 T45 PIN TORX, Stainless Steel	2
4	150-99DF-FAG-P	PILASTER FIELD ANGLE GUIDE	1
5	150-99DF-SD-P	PILASTER BOX WELDMENT	1
6	150-99DF-SD3-P-LH-DS	PILASTER DEFENDER SHROUD AND PULL, LH, WITH DOOR STOP	1
7	150-99DF-SD3-P-RH-DS	PILASTER DEFENDER SHROUD AND PULL, RH, WITH DOOR STOP	1
8	150-99DF-SD6	INDICATOR LIGHT GUARD WELDMENT	2
9	216-9900-260L	9900 Strike Plate LH / RHRB	1
10	216-9900-260R	9900 Strike Plate RH / LHRB	1
11	216-99DF-SD5	DEFENDER SHROUD STRIKE	2
12	216-99DF-SD5-S14	14 GA SHIM FOR SHROUD STRIKE	2
13	216-99DF-SD5-S16	16 GA SHIM FOR SHROUD STRIKE	2
14	216-99DF-SD6-LG-BP	BACKUP PLATE FOR LIGHT GUARD	2
15	216-99DF-SDC-P	PILASTER DEFENDER BOX COVER	1
16	216-99DF-SR64	SR 64 DOOR SILENCER	4
17	217-0000-017-D	650 DOOR STOP FOR DEFENDER BOX	2
18	310-1032-014	SET SCREW, 10-32 X .25	2
19	310-3816-033	SCREW, SHCS 3/8-16 X .500 WITH LOCKING PATCH	6
20	311-2520-082	Screw, FH, Pin TORX, 1/4-20x1/2, Stainless Steel, UC Head	21
21	311-2520-108	Screw, TP, BH Torx 1/4-20x3/8 SS	8
22	311-2520-114	Screw, TP, BH Torx PLUS 1/4-20x3/8 SS	12
23	311-3816-008	Screw FH pin TORX 3/8-16x .75" Zinc Plated	10
24	312-3118-000	NYLOCK NUT, 5/16-18	8
25	313-0000-002	WSHR FLAT 5/16 TYPE B REG STL PLT	8
26	313-0000-004	Washer, Split Lock, 5/16, Steel, Zinc Plated	8
27	313-0000-115	Washer Lock split spring 3/8 Zinc Plated	6
29	Panel Mount Key Switch	Job Specific	4



**AIRTEQ**

www.airteq.com

800-466-3007

## **SIDE BY SIDE DEFENDER**

7/2/20

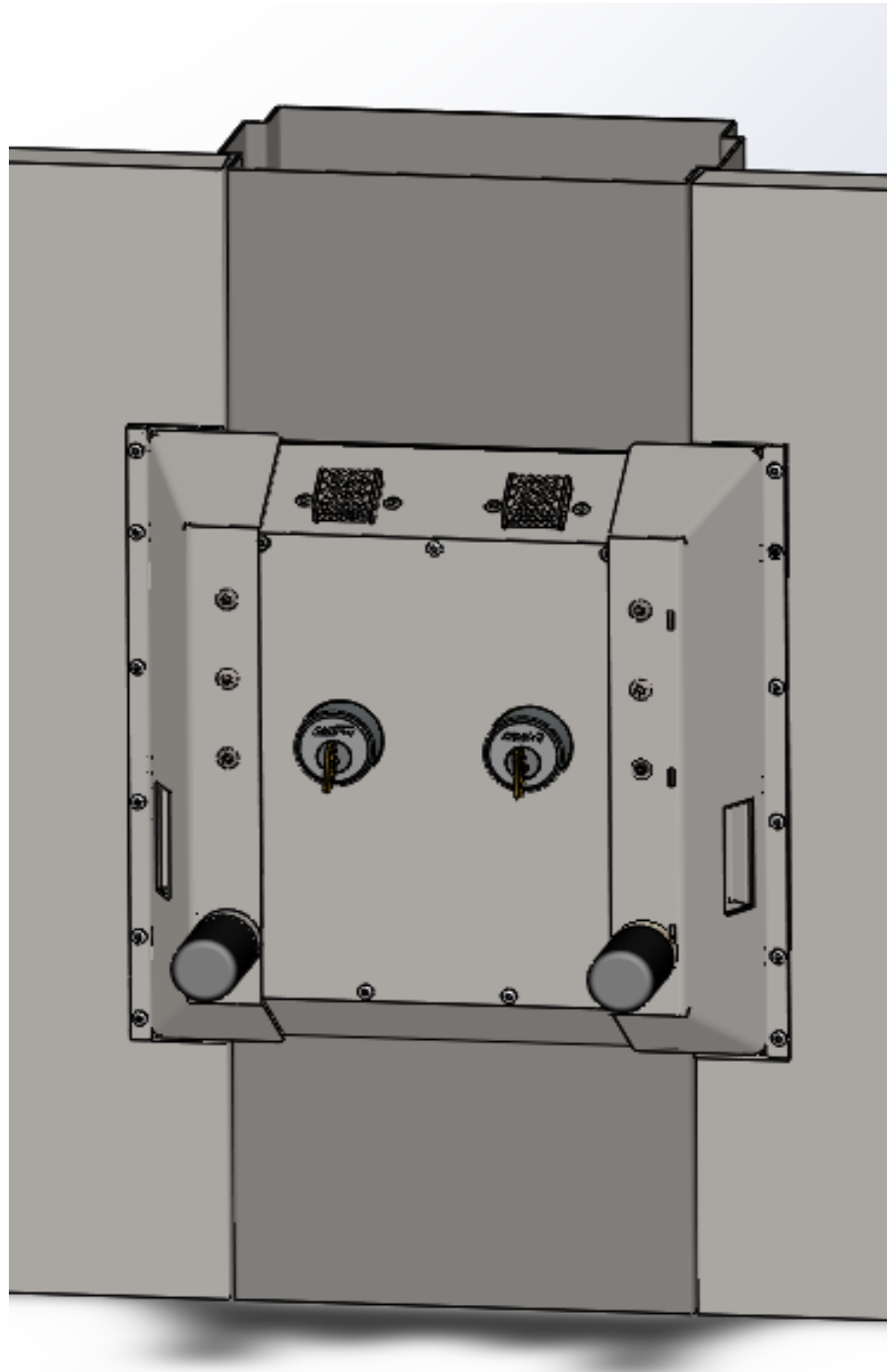



**AIRTEQ**

www.airteq.com  
800-466-3007

# SIDE BY SIDE DEFENDER

5/6/2020

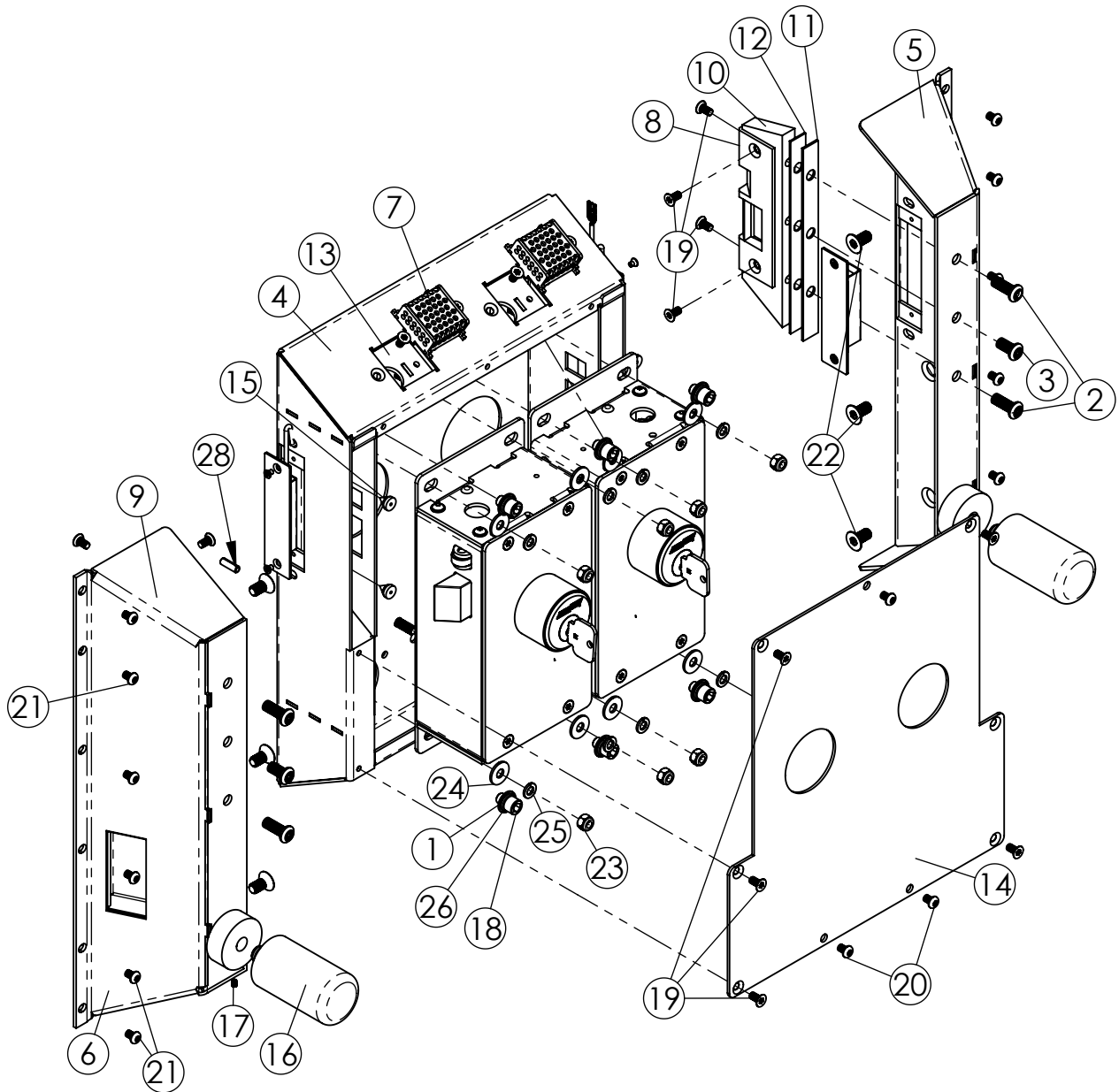



**AIRTEQ**

www.airteq.com

800-466-3007

**SIDE BY SIDE DEFENDER**

5/6/2020

ITEM NO.	PART NUMBER	DESCRIPTION	QTY.
1	10000708	WASHER, FLAT, 3/8 SAE, ZP	6
2	10003401S	SCREW BHMS 3/8-16x1 T45 PIN TORX, Stainless Steel	4
3	10003407S	SCREW BHMS 3/8-16x3/4 T45 PIN TORX, Stainless Steel	2
5	150-99DF-SD-SBS	SIDE BY SIDE DEFENDER BOX WELDMENT	1
6	150-99DF-SD3-LH-DS	DEFENDER SHROUD AND PULL, LH, WITH DOOR STOP	1
7	150-99DF-SD3-RH-DS	DEFENDER SHROUD AND PULL, RH, WITH DOOR STOP	1
8	150-99DF-SD6	INDICATOR LIGHT GUARD WELDMENT	2
9	216-9900-260L	9900 Strike Plate LH / RHRB	1
10	216-9900-260R	9900 Strike Plate RH / LHRB	1
11	216-99DF-SD5	DEFENDER SHROUD STRIKE	2
12	216-99DF-SD5-S14	14 GA SHIM FOR SHROUD STRIKE	2
13	216-99DF-SD5-S16	16 GA SHIM FOR SHROUD STRIKE	2
14	216-99DF-SD6-LG-BP	BACKUP PLATE FOR LIGHT GUARD	2
15	216-99DF-SDC-SBS	SBS DEFENDER BOX COVER	1
16	216-99DF-SR64	SR 64 DOOR SILENCER	4
17	217-0000-017-D	650 DOOR STOP FOR DEFENDER BOX	2
18	310-1032-014	SET SCREW, 10-32 X .25	2
19	310-3816-033	SCREW, SHCS 3/8-16 X .500 WITH LOCKING PATCH, MCM # 91205A618	6
20	311-2520-082	Screw, FH, Pin TORX, 1/4-20x1/2, Stainless Steel, UC Head	18
21	311-2520-108	Screw, TP, BH Torx 1/4-20x3/8 SS	3
22	311-2520-114	Screw, TP, BH Torx PLUS 1/4-20x3/8 SS	12
23	311-3816-008	Screw FH pin TORX 3/8-16x .75" Zinc Plated	6
24	312-3118-000	NYLOCK NUT, 5/16-18	8
25	313-0000-002	WSHR FLAT 5/16 TYPE B REG STL PLT	8
26	313-0000-004	Washer, Split Lock, 5/16, Steel, Zinc Plated	8
27	313-0000-115	Washer Lock split spring 3/8 Zinc Plated	6
28	316-9900-030	Slotted Steel Spring Pin, 1/4ODx3/4 Length, McMaster 98296A924 or eq.	2



# Airteq Defender

## Reference List – February 2023

<i>Facility Name</i>	<i>Contact</i>	<i>Phone</i>	<i>Project Value</i>	<i>Devices Installed</i>
Warren County Correctional Warren County, OH	Eddie Polling Maintenance	513-932-3388	\$254,300.00	700 Each
Cullman County Detention Ctr. Cullman, AL	Major Matt Hogue Administration	256-255-5145	\$ 28,444.00	12 Each
Cullman County Detention Ctr. Cullman, AL	Floyd Lee Facility Warden	256-708-0470	\$136,500.00	50 Each
Tipton County Jail Covington, TN	Ricky Norman Maintenance	901-569-5720	\$ 14,100.00	15 Each
Paulding County Jail Dallas, GA	Lt. Keith Thomas Administration	770-560-4621	\$ 10,765.00	10 Each
Cocke County Jail Newport, TN	Forrest Clevenger County Commissioner	423-237-3521	\$ 11,000.00	50 Each
Caddo Correctional Center Parish of Caddo, LA	Maurice Carson Maintenance Supervisor	318-677-5254	\$845,300.00	650 Each
McCracken County Jail McCracken County, KY	Bobby Dennis Maintenance Supervisor	270-448-1555	\$102,900.00	50 Each
Marshall County Jail Guntersville, AL	Chief Doug Gibbs	256-960-4557	\$148,200.00	10 Each
Muscogee Cnty Jail Columbus, GA	Lt. Cynthia Zeisloft	706-641-5327	\$120,879.00	145 Each
Jefferson Cnty. Jail Birmingham, AL	Steve Cockrell General Services Operations Manager	205-237-4612	\$852,690.00	589 Each





# Airteq Defender

## Reference List - February 2023

<i>Facility Name</i>	<i>Contact</i>	<i>Phone</i>	<i>Project Value</i>	<i>Devices Installed</i>
Hays State Prison Trion, GA	Richard Stow Maintenance	478-342-4699	\$225,200.00	197 Each
Valdosta State Prison Valdosta, GA	Earnest Howard Maintenance	229-259-2541	\$108,750.00	75 Each

